

Collaborative Research and Practice in PEDIATRIC PSYCHOLOGY

March 30–April 1, 2017



PORTLAND, OREGON

SOCIETY OF
PEDIATRIC
PSYCHOLOGY
ANNUAL
CONFERENCE

SPPAC



WELCOME TO THE 2017 SOCIETY OF PEDIATRIC PSYCHOLOGY ANNUAL CONFERENCE

Welcome to the Society of Pediatric Psychology Annual Conference (SPPAC). Within this program you will find information regarding the preconference workshops, plenary addresses, concurrent symposia, poster presentations, and continuing education. Information regarding transportation and dining options are also included.

The theme for this year's conference is Collaborative Research and Practice in Pediatric Psychology. We have assembled an excellent program that highlights the collaborative work begun done by pediatric psychologists and our colleagues in other health professions. We are excited to offer an innovative program for SPPAC 2017!

We are pleased that SPPAC continues to grow as the premier conference for advancing science and practice in pediatric psychology. We again surpassed our record for number of conference proposals across all submission categories this year, which reflects SPP members' enthusiasm for our society's conference and the work of pediatric psychology.

Many individuals contributed to the success of SPPAC 2017, including members of our conference planning committee, the Society of Pediatric Psychology Board of Directors, conference sponsors, and our conference planners. Acknowledgements of individuals who were integral to the success of the conference are provided throughout the program.

Finally, we thank conference attendees for your support of SPPAC year after year. Individuals who attend the conference provide important vitality to SPPAC. Without your interest, expertise, and scientific contributions, SPPAC would not be possible. We hope you enjoy the conference and we look forward to seeing you in Orlando in 2018!

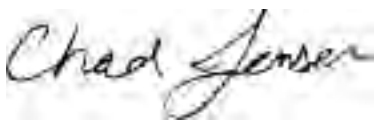

Chad Jensen, PhD
Conference Chair



Erica Sood, PhD
Conference Co-Chair

Contents

General Information	3
Acknowledgments.....	4
About Our Plenary Speakers.....	5
Detailed Conference Program	6-12
Thursday-at-a-Glance	7
Friday-at-a-Glance	10
Saturday-at-a-Glance.....	12
Continuing Education	13
Learning Objectives.....	14-19
Poster Session 1.....	20
Poster Session 2.....	23
Poster Session 3.....	27
Poster Session 4.....	30
Congratulations to the 2017 SPP Award Winners	34
Meeting Room Maps.....	35
Sponsor Advertisements	36-38
SPPAC 2018.....	39
Sponsors	Back Cover

GENERAL INFORMATION

Conference Objectives

The SPPAC aims to advance SPP's mission to promote the health and psychological well-being of children, youth and their families through science and an evidence-based approach to practice, education, training, advocacy, and consultation by:

1. Advancing the science of pediatric psychology and related fields through dissemination of cutting edge research; promotion of research that is culturally, ethically and developmentally sensitive and includes diverse populations; and education on evidence-based assessment, intervention, and emerging areas of research, clinical care, and policy.
2. Providing a forum for individuals at all levels, from students to established investigators and clinicians, to facilitate consultation, collaboration, and mentorship.
3. Promoting the role and value of pediatric psychology in a changing healthcare environment nationally and internationally.

Continuing Education

The Society of Pediatric Psychology (Division 54 of the American Psychological Association) is approved by the American Psychological Association to sponsor continuing education for psychologists. The Society of Pediatric Psychology maintains responsibility for this program and its contents. There are 14 scheduled hours of Introductory to Intermediate level CEs for psychologists offered at SPPAC 2017, with additional CEs available for those who attend the preconference workshops. Sessions that have been approved to receive CE credits are marked with a CE on the conference schedule.

Documentation of attendance will be made available electronically through the SPPAC User Portal (<http://convention.societyofpediatricpsychology.org/>) to those individuals who met the requirements of full attendance (at least 85% based on scan in/out information) and timely completion of an evaluation. For additional CE information, please refer to page 13 in this program.

Please remember: In order for SPP to maintain approval to sponsor continuing education, we cannot award credit for partial attendance at a session. Participants are responsible for ensuring they scan in and out on time for each session. Our trainee volunteers make this process possible, so please be respectful of them. For questions related to continuing education for SPPAC 2017, please speak with Dr. Jennifer Hansen-Moore, SPP Member-at-Large for Continuing Education.

Registration

All conference attendees, including presenters, guests, and participants, must register and wear a badge.

Meals/Receptions

A continental breakfast will be served each day. Thursday and Friday night receptions will include hors d'oeuvres. Restaurant options are available at the registration desk or a separate PDF provided on the SPPAC website.

International Attendees

We welcome our international conference attendees. Each international attendee will have the world logo on their name badge. Please welcome these individuals who have traveled far to join us.



Area Information

A complete guide to Portland assembled by Amy Holley and Kimberly Reynolds, SPPAC 2017 planning committee members and Portland residents, can be found at <http://www.societyofpediatricpsychology.org/node/681>.

Public Transportation

Trimet: www.trimet.org

Rail, bus, and streetcar services all run via the Trimet system. There is a free app you can download, or use the website. The Maps app on iPhones also connects with Trimet when you click the public transit option when getting directions.

Food

Pine Street Market: Food hall and culinary themed marketplace. Open floor plan with communal seating surrounded by nine restaurants featuring the top chefs and restaurant operators in the city. <http://www.pinestreetpdx.com/> Open 7 a.m.–1 p.m., 126 SW 2nd Ave.

Food Carts: <http://www.foodcartspdx.com/maps/>

- OHSU Pod: SW Moody Ave x SW Whitaker St.
- Downtown Pod: SW 9th Ave x SW Alder St.
- PSU Pod: SW 4th Ave x SW Hall St.

Donuts:

- Voodoo Donuts: SW 3rd x SW Ankeny
- BlueStar Donuts: SW Washington x SW 13th
- Coco Donuts: SW 6th x Yamhill

Coffee: <http://pdx.eater.com/maps/20-great-portland-coffee-shops> or <http://www.wweek.com/portland/blog-29489-here-is-a-list-of-every-coffee-roaster-in-portland-we-think.html>

A vibrant coffee scene of local roasters and coffee shops are all over Portland. We encourage you to expand beyond your regular daily cup at a chain and visit a local shop. They are everywhere.

Ice Cream phenomenon: <http://pdx.eater.com/maps/best-ice-cream-portland-scoop-shop-restaurant>

If you have a love affair with ice cream, or even occasionally eat it before dinner, this is probably worth the trip.



ACKNOWLEDGMENTS

We thank each person listed below who generously donated their time and expertise to ensure the conference's success. Thank you!

SPPAC Planning Committee

Chad Jensen, PhD - 2017 Chair
Erica Sood, PhD - 2017 Co-Chair
Anna Maria Patino-Fernandez,
PhD
Jennifer Hansen-Moore, PhD
Jennifer Verrill Schurman, PhD
Wendy Ward, PhD
Jessica Valenzuela, PhD
Wendy Gray, PhD
Jeanette Iskander, MA
Jaclyn Lennon, MA
Amy Holley, PhD
Kimberly Reynolds, PhD
Karen Roberts
Pam Hicks

Abstract Reviewers

Anthony Alioto, PhD
Melissa Armstrong-Brine, PhD
Abbie Jordan, PhD
Brittany Gresl, PhD
Andrew Riley, PhD
David Fedele, PhD
Kathryn Hoffses, PhD
Hobart Davies, PhD
Ashley Junghans-Rutelonis,
PhD
Cate Flanagan-Priore, PhD
Christopher Cushing, PhD
Danny Duke, PhD
Crystal Cederna-Meko, PsyD
Kristen Robinson Hoskinson,
PhD
Johanna Carpenter, PhD
David Jaquess, PhD
Sara Williams, PhD
Jessica Pierce, PhD
Valerie Crabtree, PhD
Cynthia Karlson, PhD
Jamie Becker, PhD
Michael Roberts, PhD
Karen Wohlheiter, PhD
Stephen Lassen, PhD
Mariella Self, PhD
Anna Wilson, PhD
Ric Steele, PhD

Marcia Winter, PhD
Simona Bujoreanu, PhD
Lisa Ingerski, PhD
Soumitri Sil, PhD
Alan Silverman, PhD
Kevin Tsang, PsyD
Amy Baughcum, PhD
Melissa Faith, PhD
Jason Boye, PhD
Diana Prescott, PhD
Kimberly Canter, PhD
Lauren Daniel, PhD
Kimberly Wesley, PsyD
Sarah VerLee, PhD
Rachel Tillery, PhD
Jacquelyn Smith, PhD
Cecelia Valrie, PhD
Line Caes, PhD
Rachel Wasserman, PhD
Deidre Edwards, PhD
Ann Davis, PhD
Victoria Willard, PhD
Shanna/Guilfoyle, PhD
Aaron Fobian, PhD
Christine Sieberg, PhD
Anai Caudra, PhD
Laura Judd-Glossy, PhD
Emily Ach, PhD
Donna Marschall, PhD
Dara Steinberg, PhD
Carolyn Ievers-Landis, PhD
Jessica Bernacki, PhD
Marissa Feldman, PhD
Jason Van Allen, PhD
Sarah Martin, PhD
Amanda Thompson, PhD
Marisa Hilliard, PhD
Ed Christophersen, PhD
Suzanne Holm, PhD
Angela Fletcher, PsyD
Johnna Jones, PhD
Kelli Triplett, PhD
Claire Russell, PhD
Kate Margolis, PhD
John Chaney, PhD
Emily Law, PhD
Jennifer Kazmerski, PhD
Jill Chorney, PhD

Nicole Dempster, PhD
Katherine Salamon, PhD
Rebecca Ellens, PsyD
Courtney Fleisher, PhD
Jessica Kichler, PhD
Eleanor Mackey, PhD
Karli Treyvaud, PsyD
Lori Crosby, PsyD
Melissa Santos, PhD
Samudragupta Bora, PhD
Jocelyn Carter, PhD
Drifa Gudmundsdottir, PhD
Lauren Garbacz, PhD
Christopher Fitzgerald, PhD
Danette Beitra, PhD
Kim Zlomke, PhD
Jennifer Lee, PhD
Margaret Mannix, PhD
Katie Devine, PhD
Laura Dewey, PhD
Robin Everhart, PhD
Marni Axelrad, PhD
Richard Boles, PhD
Valerie Paasch, PhD
Margaux Barnes, PhD
Lisa Ramirez, PhD
Grayson Holmbeck, PhD
Joanna Patten, PsyD
Virginia Cline, PhD
Maureen Monaghan, PhD
Amy Hughes Lansing, PhD
Kari Baber, PhD
Michelle Fortier, PhD
Meghan Marsac, PhD
Amy Drayton, PhD
Whitney Guerry, PhD
Holly Antal, PhD

2017-2018 Society of Pediatric Psychology Board of Directors

Celia Lescano, PhD
Sharon Berry, PhD
Ann Davis, PhD
Christine Chambers, PhD
Cynthia Gerhardt, PhD
Anne Kazak, PhD

Jeanette Iskander, MA
Eleanor Mackey, PhD
Jessica Valenzuela, PhD
Wendy Ward, PhD
Jennifer Hansen-Moore, PhD
Bryan Karazsia, PhD
Jennifer Shroff Pendley, PhD
Jennifer Verrill Schurman, PhD
Grayson Holmbeck, PhD
Tonya Palermo, PhD
Chad Jensen, PhD
Erica Sood, PhD
Laura Simons, PhD
Wendy Gray, PhD
Marilyn Sampilo, PhD
Karen Roberts

Trainee Volunteers

Jeannette Iskander
Meg Nicholl
Katy Darling
Nour Al Ghriwati
Julia Lamotte
Ana El-Behadi
Ashley Marchante
Ellen Defender
Alli Mullins
Kara Monnin
Shweta Ghosh
Kira Branch
Paul Enlow
Linda McWhorter
Colleen Bechtel Driscoll
Jessie Pogue
Kimberly Barnett
Kirandeep Kaur
Michaela Billat
Meredith Bishop
Anj Jagpal
Amin Eslami
Courtney Ball
Joanna Tsikis
Roya Amiriroumand

Conference Planners

Pam Hicks, KUPCE
Stacy Cordell, KUPCE
Marie Osterhaus, KUPCE

ABOUT OUR PLENARY SPEAKERS



International Plenary Speaker
Christine Chambers, PhD

Dr. Christine Chambers is the Canada Research Chair (Tier 1) in Children's Pain and Professor in the Departments of Pediatrics and Psychology & Neuroscience at Dalhousie University in Halifax, Nova Scotia. Dr. Chambers' research examines the role of developmental, psychological, and social influences on children's pain, with a current research focus on the role of families in pediatric pain and social media for health knowledge mobilization. Her work spans knowledge generation (e.g., original studies), knowledge synthesis (e.g., systematic review, guidelines), and knowledge translation (e.g., policy, public outreach). Dr. Chambers' presentation will focus on disseminating science to change practice in pediatric psychology.



Diversity Plenary Speaker
Glenn Flores, MD, FAAP

Dr. Glenn Flores is Distinguished Chair of Health Policy Research at the Medical Research Institute, Research Affiliate in the Department of Health Sciences Research at the Mayo Clinic, and Affiliate Professor of Health Policy & Management at the University of Minnesota School of Public Health. He is Director of the NIDDK/APA Research in Academic Pediatrics Initiative on Diversity (RAPID) and an editorial board member of *Journal of Health Care for the Poor and Underserved*. Dr. Flores' address will focus on racial/ethnic disparities in children's and adolescents' health and healthcare, including community partnerships which have successfully increased health insurance coverage and eliminated health disparities.



Plenary Speaker
Greg Fritz, MD

Dr. Gregory Fritz is Professor of Psychiatry, Director of the Division of Child and Adolescent Psychiatry, and Vice Chair of the Department of Psychiatry and Human Behavior at the Warren Alpert School of Medicine at Brown University. He is also the current president of the American Academy of Child and Adolescent Psychiatry (AACAP). Dr. Fritz's research and clinical expertise is in the mind-body interactions in chronic pediatric illness. His AACAP presidential initiative is focused on integrated care. His address will focus on collaborations between psychologists and psychiatrists in integrated care.



Plenary Speaker
Terry Stancin, PhD, ABPP

Dr. Terry Stancin is Professor of Pediatrics, Psychiatry and Psychological Sciences at Case Western Reserve University. She serves as Director of Child and Adolescent Psychiatry and Psychology and Vice-Chair for Research in Psychiatry at MetroHealth Medical Center in Cleveland, Ohio. Dr. Stancin has been a national advocate and expert in pediatric mental health issues in primary care settings for more than thirty years. In 2012 she served as the SPP representative on the APA Inter-Organizational Work Group on Competencies for Psychological Practice in Primary Care. In 2013, she spearheaded the formation of a Task Force on Integrated Care. Her presentation will focus on integrated primary care.

SPPAC 2017 CONFERENCE PROGRAM

THURSDAY, MARCH 30

7:30 a.m.

Registration and Check-in • *Ballroom Foyer*

8:30–11:30 a.m.

MORNING PRE-CONFERENCE WORKSHOPS ^{CE}

Using Acceptance and Commitment Therapy (ACT) with Adolescents with Medical Conditions: An Advanced Skill-Building Workshop (3 CEs) • *Salons G & H*

Karen E. Weiss, PhD, LP, ABPP, & Staci Martin, PhD, LP

Ethical Dilemmas in Transgender Health Care (3 CEs) • *Mt. Hood*

Diane Chen, PhD, Laura Edwards-Leeper, PhD, Terry Stancin, PhD, ABPP, & Amy Tishelman, PhD

Advances in Statistical Modeling: Practical Strategies for Addressing Complex Research Questions (3 CEs) • *Columbia*

Rachel Wasserman, PhD, Bridget Armstrong, PhD, David Barker, PhD, Kristoffer Berlin, PhD, Grayson N. Holmbeck, PhD, Bryan Karazsia, PhD, & Betty Lai, PhD

Methods of Using QI Data and Statistical Process Control (SPC) – The “Quick Start Guide” (3 CEs) • *Salon I*

Richard Brilli, MD, FAAP, MCCM, Thomas Bartman, MD, PhD, Richard McClead, MD, MHA, Tammi Young-Saleme, PhD, & Catherine Butz, PhD

11:30 a.m.–1:30 p.m.

Lunch on your own

11:30 a.m.–1:30 p.m. (unless noted below)

SPECIAL INTEREST GROUP (SIG) MEETINGS

Diabetes • *Columbia*

Integrated Primary Care • *Mt. Hood*

Pediatric Research/Innovative Statistical Methods • *Meadowlark/Douglas Fir*

Adherence (11:30-12:30) • *Salon I*

Pediatric Bioethics (11:30-12:30) • *Eugene*

Adolescent and Young Adult (11:30-12:30) • *Pearl*

Pediatric Consultation and Liaison (11:30-1:00) • *Salons G & H*

Pediatric Pain (12:00-1:30) • *Portland*

Neonatology (12:30-1:30) • *Salon I*

1:30 a.m.–4:30 p.m.

AFTERNOON PRE-CONFERENCE WORKSHOPS ^{CE}

Guidelines for Establishing Integrated Pediatric Behavioral Health Care: Lessons Learned and Recommendations (1:30-3:30 p.m., 2 CEs) • *Salon I*

Joseph H. Evans, PhD, Rachel Valleley, PhD, Blake Lancaster, LP, Shelly Hosterman, PhD, Tawnya Meadows, PhD, & Holly Roberts, PhD

Death and Dying: Practical Skills for Working with Bereaved Children and Adolescents (1:30-3:30 p.m., 2 CEs) • *Columbia*
Amanda Thompson, PhD

Inspiration – Innovation – Commercialization – and Perspiration: Avoiding the Cold Sweats When Your Research Might be Valuable (3 CEs) • *Salons G & H*

Jill Chorney, PhD, Chip Sutherland, LLB, Lindsey L. Cohen, PhD, & Melissa Howlett, BSc

Understanding and Resolving Ethical Concerns that Arise During Clinical Supervision in the Pediatric Medical Setting (3 CEs) • *Mt. Hood*

Rebecca Hazen, PhD, & Karla K. Fehr, PhD

3:30–6:00 p.m.

Society of Pediatric Psychology Board of Directors Meeting • *Meadowlark/Douglas Fir*

4:30–6:30 p.m. (unless noted below)

SPECIAL INTEREST GROUP (SIG) MEETINGS

Diversity • *Salons G & H*

Cardiology • *Salon I*

Craniofacial (4:30–5:30 p.m.) • *Medford*

Complimentary and Integrative Medicine (4:30–5:30 p.m.) • *East Side*

Obesity (4:30–6:00 p.m.) • *Mt. Hood*

Epilepsy (4:30–6:00 p.m.) • *Eugene*

Pediatric Gastroenterology (4:30–6:00 p.m.) • *Pearl*

Hematology/Oncology/Blood and Marrow Transplant (4:30–6:00 p.m.) • *Columbia*

Allergic Diseases (5:00–6:30 p.m.) • *Portland*

Medical Traumatic Stress (5:30–6:30 p.m.) • *East Side*

5:30–6:15 p.m.

Student Social • *Truss Lounge*

* Sponsored by the SPP Student Advisory Board

International Attendee Social • *Truss Lounge*

6:00–7:00 p.m.

Journal of Pediatric Psychology Editorial Meeting • *Medford*

6:15–7:00 p.m.

Demystifying Internship: Q&A for Students • *Mt. Hood*

7:00–8:00 p.m.

Welcome Reception and Poster Session 1 ^{CE} • *Exhibit Hall*
(Must remain for entire hour to obtain CE credit)

Hors d'oeuvres will be served

* Poster Session Sponsored by Brigham Young University

THURSDAY AT-A-GLANCE

	Columbia	East Side	Eugene	Meadowlark/ Douglas Fir	Medford	Mt. Hood	Pearl	Portland	Salon G&H	Salon I
7:30	Registration and Check-in • Ballroom Foyer									
8:30-11:30	Advances in Statistical Modeling: Practical Strategies for Addressing Complex Research Questions					Ethical Dilemmas in Transgender Health Care			Using Acceptance and Commitment Therapy (ACT) with Adolescents with Medical Conditions: An Advanced Skill-Building Workshop	Methods of Using QI Data and Statistical Process Control (SPC) – The “Quick Start Guide”
11:30-1:30	Lunch on your own									
11:30-12:30			Pediatric Bioethics				Adolescent and Young Adult			Adherence
11:30-1:00									Pediatric Consultation and Liaison	
11:30-1:30	Diabetes			Pediatric Research/ Innovative Statistical Methods		Integrated Primary Care				
Noon-1:30								Pediatric Pain		
12:30-1:30										Neonatology
1:30-3:30	Death and Dying: Practical Skills for Working with Bereaved Children and Adolescents									Guidelines for Establishing Integrated Pediatric Behavioral Health Care: Lessons Learned and Recommendations
1:30-4:30						Understanding and Resolving Ethical Concerns that Arise During Clinical Supervision in the Pediatric Medical Setting			Inspiration – Innovation – Commercialization – and Perspiration: Avoiding the Cold Sweats When Your Research Might be Valuable	
3:30-6:00				Society of Pediatric Psychology Board of Directors Meeting						
4:30-5:30		Complimentary and Integrative Medicine			Craniofacial					
4:30-6:00	Hematology/ Oncology/Blood and Marrow Transplant		Epilepsy			Obesity	Pediatric Gastroenterology			
4:30-6:30									Diversity	Cardiology
5:00-6:30								Allergic Diseases		
5:30-6:30		Medical Traumatic Stress								
5:30-6:15	Student and International Attendee Social • Truss Lounge									
6:00-7:00	Journal of Pediatric Psychology Editorial Meeting • Medford									
6:15-7:00	Demystifying Internship: Q&A for Students • Mt. Hood									
7:00-8:00	Welcome Reception and Poster Session 1 • Exhibit Hall									

FRIDAY, MARCH 31

6:00–7:00 a.m.

Yoga; Kimberly Reynolds, PhD, Instructor (all are welcome) • *Salmon*
* Physical Activity Sponsored by Pacific University

7:00–8:00 a.m.

Clinical Practice in Pediatric Psychology Editorial Meeting • *Pearl*

7:30 a.m.

Registration and Check-in • *Ballroom Foyer*

8:00–9:00 a.m.

Continental Breakfast and Poster Session 2 ^{CE} • *Exhibit Hall*
(Must remain for entire hour to obtain CE credit)
* Poster Session Sponsored by Seattle Children's Hospital

9:15–10:00 a.m.

Conference Welcome • *Salons A-F*
Presidential Address
SPP Awards Presentation

10:00–11:00 a.m.

Plenary Address ^{CE} • *Salons A-F*
Pediatric Primary Care – Rationale and Progress
Gregory Fritz, MD

11:00–11:15 a.m.

Refreshment Break • *Exhibit Hall*

11:15 a.m.–12:15 p.m.

CONCURRENT PROFESSIONAL DEVELOPMENT WORKSHOPS ^{CE}

Establishing and Maintaining a Grant-Funded Program of Research • *Salons G & H*
Presenter: Anthony Spirito, PhD

Negotiating for Career Success in Pediatric Psychology • *Mt. Hood*
Presenter: Lori Stark, PhD

Becoming a Successful (and Ethical) Clinical Supervisor and Mentor • *Columbia*
Presenter: Elissa Jelalian, PhD

Publishing 101: Maximizing Your Chances of Success • *Salon I*
Presenters: Jennifer Schurman, PhD, Jennifer Shroff Pendley, PhD, Tonya Palermo, PhD, & Grayson Holmbeck, PhD

12:30–1:30 p.m.

Mentoring Lunch (*Pre-registration required*) • *Exhibit Hall*
All other conference attendees: Lunch on your own

1:45–2:45 p.m.

CONCURRENT SYMPOSIA ^{CE}

Unique Collaborations with State, County and Commercial Payers to Develop Comprehensive Pediatric Psychology Services • *Mt. Hood*
Chair: Michael A. Harris, PhD
Discussant: Heather Huszti, PhD

Intensive Inpatient Multidisciplinary Program for Children with Severe Feeding Disorders: Partnering with Commercial Insurance

Cindy Kim, Robin Robinson, & Mitchell Katz

Providing Pediatric Psychology Services Across a Continuum of Care: Creating a County-Funded Specialty Mental Health Clinic

Adrienne N. Alpern, Julie Moghal, Marissa Corona, Carlos Y. Konishi, Carolina D. Eberhard Veira, & Heather C. Huszti

Partnering with Medicaid in Caring for Youth with Medical and Social Complexity

Michael Harris

Culturally Responsive Assessments and Interventions to Address Pediatric Obesity: A Collaborative Symposium of the Diversity and Obesity SIGs • *Salon I*

Chair: Idia B. Thurston, PhD

Discussant: Elizabeth Getzoff Testa, PhD

Developing a Culturally-Responsive Behavioral Health Intervention for Disordered Eating Among Adolescents: From Theoretical Conceptualization to Implementation
Rebecca C. Kamody, Idia B. Thurston, & E. Thomaseo Burton

Focused Discussion Groups: A Culturally-Responsive Strategy for Bridging Research and Practice in a Pediatric Obesity Clinic

Tiffany M. Rybak, Kristina M. Decker, Idia B. Thurston, Thomaseo Burton, & Joan C. Han

Adaptando Dieta y Accion Para Todos (ADAPT): Targeting Diet and Physical Activity of Latinos Living in Rural Communities in Florida

Marilyn Stern, Celia M. Lescano, Humberto López Castillo, Courtney Lynn, & Jennifer Bleck

Strategies to Improve Recruitment, Retention, and Outcomes in a Culturally Tailored Pediatric Obesity Intervention

Gina L. Tripicchio, Kelsey Dean, Christie Befort, & Ann M. Davis

Provider-Patient Interactions within Pediatric Medical Care: Challenges and Opportunities for Promoting Collaboration • *Salons G & H*

Chair/Discussant: Laura Smith, PhD, CDE, & Jessica Valenzuela, PhD

Adolescents' Perspectives of Provider-Patient Interactions in Type 2 Diabetes

Roya Amirniroumand, Jessica M. Valenzuela, Laura B. Smith, Meg C. Nicholl, Lawrence M. Dolan, & Scott W. Powers

Communication Among Adolescents and Young Adults with CKD, Caregivers, and Providers During Clinic Visits: Developmental Considerations

Shayna S. Coburn, Michelle N. Eakin, Debra Roter, Cozumel Pruette, Tammy Brady, Susan Mendley, Shamir Tuchman, Barbara Fivush, & Kristin A. Riekert

Improving Chronic Care Delivery via Technology-Enabled Patient-Clinician Co-Production

Lisa Opipari, Sunny Thakkar, Dana Dykes, Lisa Burns, Barb Chini, Gary McPhail, Shehzad Saeed, Peter Margolis, Ian Eslick, & Heather Kaplan, Courtney Lynn, & Jennifer Bleck

FRIDAY, MARCH 31 (CONTINUED)

Outstanding Pediatric Psychology Research by Students and Trainees • *Columbia*

Chair/Discussant: Eleanor Mackey, PhD

Understanding Trauma and Health for Foreign-Born Latino Youth in the Primary Care Setting

Ashley Marchante, Maria Jimenez-Munoz, Anai Cuadra, Elizabeth Pulgaron, & Annette La Greca

Alcohol Use Disclosure in Adolescents and Young Adults with Type 1 Diabetes

MaryJane Simms & Maureen Monaghan

Assessment of Neurocognitive Late Effects, Academic Functioning, and School-based Services in Childhood Cancer Survivors

Shelby Wilson, Alix McLaughlin, Natalie Morris, & Catherine Peterson

Working with a National Parenting Magazine to Reach Parents with Evidence-based Vaccination Pain Management Strategies

Katelynn E. Boerner, Christine T. Chambers, C. Meghan McMurtry, Noni MacDonald, Melanie Barwick, Anna Taddio, & Kathryn A. Birnie

2:45–3:00 p.m.

Refreshment Break • *Exhibit Hall*

3:00–4:00 p.m.

Diversity Plenary Address ^{CE} • *Salons A-F* Racial/Ethnic Disparities in Children's Health, Healthcare, and Mental Healthcare, and Community-Based Interventions Which Eliminate These Disparities

Glenn Flores, MD, FAAP

4:15–6:15 p.m.

CONCURRENT SYMPOSIA ^{CE}

Comprehensive, Collaborative, and Integrative Care for Transgender Adolescents • *Columbia*

Chair: Laura Edwards-Leeper, PhD

Discussant: Amy Tishelman, PhD

Overview and History of Treatment of Transgender Adolescents in the US, Professional Guidelines Directing Services, and the Mental Health Service Needs Going Forward

Tabi Evans & Ariana Greene

Why Mental Health Providers are Needed in the Care of Transgender Adolescents

Alyshia Smith & Laura Edwards-Leeper

Medical Interventions and Medical Providers' Perception of Collaborating with Mental Health Providers

Karin Selva & Laura Edwards-Leeper

Training the Next Generation of Clinical Psychology Graduate Students in Working with Transgender Youth

Anastasia Jones, Aurora Griffin, Kara Friend & Kelly Haugen

Leveraging Learning Health Registries to Guide Collaborative Research and Practice in Pediatric Chronic Conditions • *Salon I*

Chair: Rashmi P. Bhandari, PhD

Discussant: Mark Connelly, PhD

Utilization of LHS Registries to Optimize Interdisciplinary Collaboration and Facilitate Precision Health Care

Rashmi Bhandari

Bridging Silos – Using a LHS Registry to Advance Clinical and Research Collaborations

Rachael Coakley & Deidre Logan

Canadian Pediatric Chronic Pain Registry (CPCPR) Using the Collaborative Health Outcomes Information Registry (CHOIR): A First Step Towards Improving Health Outcomes in Childhood Chronic Pain

Jennifer Stinson & Kathryn Birnie

Engaging Stakeholders in Pediatric Psychology Research: Partnering with Patients, Healthcare Providers and Communities • *Mt. Hood*

Chair/Discussant: Jill Chorney, PhD

Engaging Stakeholders in the Development of a Computer Program Designed to Prepare Children and Their Parents for Pediatric Radiation Therapy

Nikita P. Rodrigues, Lindsey L. Cohen, Kevin M. Swartout, Anya Griffin, & Karen McCarthy

Finding the BALANCE: Collaborating with Stakeholders to Guide a Research Program to Improve the Perioperative Experiences of Children with Autism Spectrum Disorder

Stephanie Snow, Isabel Smith, & Jill Chorney

Addressing Researcher Distrust in Community Partnerships by Being the Change We Want to See

Alvina Rosales, Wendy Shlater, Michelle Fortier, Zeev Kain, & Nancy Huerta

Dissemination and Implementation of Pain and Mental Health Screening in Pediatric Chronic Conditions • *Salons G & H*

Chair: Alexandra Quittner, PhD

Discussant: Tonya M. Palermo, PhD

Psychosocial and Family Risk Screening for Youth with Headache in a Pediatric Neurology Clinic

Emily F. Law

Universal Psychological Screening as a Promising Precision Medicine Tool for Antiepileptic Drug Selection in Pediatric Epilepsy

Shanna Guilfoyle

Integration of Mental Health Screening into Pediatric Specialty Clinics: Automated Assessment of Multiple Patient Reported Outcomes (PROs) in a Diabetes Clinic

Jessica Kichler

Development and Implementation of Mental Health Screening Guidelines in CF Centers Nationally

Alexandra Quittner

7:00–8:00 p.m.

Reception and Internships/Fellowships on Parade • *Exhibit Hall*

FRIDAY AT-A-GLANCE

	Columbia	Mount Hood	Pearl	Salmon	Salon G&H	Salon I
6:00-7:00				Yoga; Kimberly Reynolds		
7:00-8:00			Clinical Practice in Pediatric Psychology Editorial Meeting			
7:30	Registration and Check-in • Ballroom Foyer					
8:00-9:00	Continental Breakfast and Poster Session 2 • Exhibit Hall					
9:15-10:00	Conference Welcome / Presidential Address / SPP Awards Presentation • Salons A-F					
10:00-11:00	Plenary Address: Gregory Fritz, MD • Salons A-F Pediatric Primary Care – Rationale and Progress					
11:00-11:15	Refreshment Break • Exhibit Hall					
11:15-12:15	Becoming a Successful (and Ethical) Clinical Supervisor and Mentor	Negotiating for Career Success in Pediatric Psychology			Establishing and Maintaining a Grant-Funded Program of Research	Publishing 101: Maximizing Your Chances of Success
12:30-1:30	Mentoring Lunch • Exhibit Hall All other conference attendees: Lunch on your own					
1:45-2:45	Outstanding Pediatric Psychology Research by Students and Trainees	Unique Collaborations with State, County and Commercial Payers to Develop Comprehensive Pediatric Psychology Services			Provider-Patient Interactions within Pediatric Medical Care: Challenges and Opportunities for Promoting Collaboration	Culturally Responsive Assessments and Interventions to Address Pediatric Obesity: A Collaborative Symposium of the Diversity and Obesity SIGs
2:45-3:00	Refreshment Break • Exhibit Hall					
3:00-4:00	Diversity Plenary Address: Glenn Flores, MD, FAAP • Salons A-F Racial/Ethnic Disparities in Children's Health, Healthcare, and Mental Healthcare, and Community-Based Interventions Which Eliminate These Disparities					
4:15-6:15	Comprehensive, Collaborative, and Integrative Care for Transgender Adolescents	Engaging Stakeholders in Pediatric Psychology Research: Partnering with Patients, Healthcare Providers and Communities			Dissemination and Implementation of Pain and Mental Health Screening in Pediatric Chronic Conditions	Leveraging Learning Health Registries to Guide Collaborative Research and Practice in Pediatric Chronic Conditions
7:00-8:00	Reception and Internships/Fellowships on Parade • Exhibit Hall					

SATURDAY, APRIL 1

6:00–7:00 a.m.

Cardiovascular Exercise; Alissa Lesperance, Instructor
(all are welcome) • *Salmon*
* Physical Activity Sponsored by Pacific University

7:00–8:00 a.m.

SIG Chairs Meeting • Willamette
ABCCAP Informational Meeting • Pearl

8:00–9:00 a.m.

Continental Breakfast and Poster Session 3 ^{CE} • *Exhibit Hall*
(Must remain for entire hour to obtain CE credit)
* Poster Session Sponsored by Doernbecher Children's Hospital

9:15–10:15 a.m.

International Plenary Address ^{CE} • *Salons A-F*
Implementation Science and Pediatric Psychology: From Evidence to Influence
Christine Chambers, PhD

10:15–10:30 a.m.

Refreshment Break • Exhibit Hall

10:30–11:30 a.m.

Plenary Address ^{CE} • *Salons A-F*
Finding a Place at the Table: Pediatric Psychology Opportunities in Integrated Care Settings
Terry Stancin, PhD, ABPP

11:45 a.m.–12:45 p.m.

Poster Session 4 ^{CE} • *Exhibit Hall*
(Must remain for entire hour to obtain CE credit)

12:45–2:00 p.m.

Student Advisory Board Meeting • Willamette
All other conference attendees: Lunch on your own

2:00–4:00 p.m.

CONCURRENT SYMPOSIA ^{CE}

Neurodevelopmental Late Effects in Pediatric Brain Tumor Survivors: From Understanding to Intervention • Columbia
Chair: Matthew Hocking, PhD
Discussant: Stephen Sands, PsyD

Neurocognitive Change over Time in Pediatric Brain Tumor Patients Treated with Proton Beam Radiation Therapy Versus Surgery Only

Lisa S. Kahalley, M. Douglas Ris, Anita Mahajan, M. Faith Okcu, Murali Chintagumpala, William Whitehead, Arnold C. Paulino, Leigh H. Muths, Jessica Orobio, Charles Minard, & David R. Grosshans

Biological Substrates of Impaired Neurocognitive Functioning: Understanding the Late Effects of Surviving a Pediatric Brain Tumor

Stephen A. Sands, Dennis Shaw, Nancy Rollins, Jesse Bledsoe, Alice A. Holland, Jerry Wang, Andrew Poliakov, Mirko Savone, David Semanek, & Jonathan E Posner

Efficacy of a Computerized Cognitive-Training Program in Long-Term Pediatric Brain Tumor Survivors

Julie N. Baran, Lauren F. Quast, Iris Paltin, Lamia P. Barakat, & Matthew C. Hocking

Connecting in Schools: Adaptation and Feasibility of a School-Based Peer-Mediated Intervention to Improve Social Competence of Childhood Brain Tumor Survivors

Katie A. Devine, William M. Bukowski, Olle Jane Z. Sahler, Pamela Ohman-Strickland, Tristram H. Smith, Anne Lown, Andrea Farkas Patenaude, David N. Korones, & Robert B. Noll

Collaborative Efforts in Treating Youth with Medical and Social Complexity: Systems Autopsies • Salon I

Chair: Michael A. Harris, PhD

The Continuum of Care for Youth with Medical Complexity: Medicaid Perspective

Helen Bellanca

Systems Challenges in Paying for Comprehensive Services for Youth with Medical Complexity: APMs and Bundled Payments

Liz Boileau

Collaborative Efforts and Systems Challenges in Treating Youth with ESRD: A Case Example

David Rozansky

Collaborative Efforts and Systems Challenges in Treating Youth with Sickle Cell: A Case Example

Trisha Wong

The Role of Schools in the Management of Youth with Medical Complexity

Frances O'Connor

SATURDAY, APRIL 1 (CONTINUED)

Resilience Manifested: Examining Strength and Protective Factors in Pediatric Pain • *Mt. Hood*

Chair: Lindsey L. Cohen, PhD

Discussant: Laura E. Simons, PhD

Uncovering Strength and Exploring Resilience in Adolescents with Sickle Cell Pain

Laura A. Cousins, Lindsey L. Cohen, & Soumitri Sil

Positive Psychological Resources and Health-Related Quality of Life in Pediatric Abdominal Pain

Rachel M. Tomlinson, C. Meghan McMurtry, & Kevin C. Bax

Finding Resilience in the Pain Narratives of Children and Parents

Melanie Noel, Jill Chorney, Susan Graham, Maria Pavlova, Jillian Vinall, Sarah E. Beals-Erickson, Emily F. Law, Nicole Alberts, & Tonya M. Palermo

All in the Family: Intergenerational Models Informing Prevention Efforts in Pediatric Populations • *Salon G & H*

Chair: Amanda L. Stone, MS

Discussant: Anna C. Wilson, PhD

Developing and Testing an Integrative Model for the Transmission of Risk for Chronic Pain from Parents to Offspring

Amanda L. Stone

Pre-pregnancy Maternal BMI Influences Childhood Asthma Medication Dispensing

Kelvin MacDonald & Cindy McEvoy

The Impact of Parental Chronic Pain: Pathways to Child Pain Increases

Anna C. Wilson & Tonya M. Palermo

Family-Based Depression Prevention in At-Risk Youth

Alexandra Bettis, Rex Forehand, & Bruce Compas

4:00 p.m.

Adjourn

SATURDAY AT-A-GLANCE

	Columbia	Mount Hood	Pearl	Salmon	Salon I	Salons G&H	Willamette
6:00-7:00				Cardiovascular Exercise; Alissa Lesperance			
7:00-8:00			ABCCAP Informational Meeting				SIG Chairs Meeting
8:00-9:00	Continental Breakfast and Poster Session 3 • Exhibit Hall						
9:15-10:15	International Plenary Address: Christine Chambers, PhD • Salons A-F Implementation Science and Pediatric Psychology: From Evidence to Influence						
10:15-10:30	Refreshment Break • Exhibit Hall						
10:30-11:30	Plenary Address: Terry Stancin, PhD, ABPP • Salons A-F Finding a Place at the Table: Pediatric Psychology Opportunities in Integrated Care Settings						
11:45-12:45	Poster Session 4 • Exhibit Hall						
12:45-2:00	Student Advisory Board Meeting • Willamette All other conference attendees: Lunch on your own						
2:00-4:00	Neurodevelopmental Late Effects in Pediatric Brain Tumor Survivors: From Understanding to Intervention	Resilience Manifested: Examining Strength and Protective Factors in Pediatric Pain			Collaborative Efforts in Treating Youth with Medical and Social Complexity: Systems Autopsies	All in the Family: Intergenerational Models Informing Prevention Efforts in Pediatric Populations	
4:00	Adjourn						

CONTINUING EDUCATION INFORMATION



Conference Sessions Approved for CE Credit

There are 14 scheduled hours of Introductory to Intermediate level CEs for psychologists offered at SPPAC 2017, with additional CEs available for those who attend the preconference workshops.

Sessions that have been approved to receive

CE credits are noted in the program with the CE logo. Learning objectives, as well the number of CEs approved for each session, are provided to aid in attendee planning below. Potential conflicts of interest are indicated, where known.

If you are interested in receiving CE credit for approved sessions, you will need to follow all instructions below:

- 1. Scan your badge at a kiosk provided outside of the door of each CE approved session, BOTH at the beginning and at the end of the session.** You must be present for at least 85% of the session in order to receive credit. Percent of time present in the room will be determined by the time in/time out stamp from scanning. Thus, if you do not get scanned in OR out of the room, or get scanned into the room late and/or out of the room early, no CE credit will be granted for that particular session.
- 2. Fill out evaluations for all sessions for which you would like to claim CE credit.** When you scan into any conference session using your badge, the SPPAC Conference Portal will e-mail you a link to the associated evaluation form. You can complete the evaluation clicking on the link or simply logging into the SPPAC Conference Portal (<http://convention.societyofpediatricpsychology.org/user>) and locating it in your "Pending" evaluations. Completing a session evaluation can be done during the session or at a later time. However, all evaluation forms are required to be submitted within 2 weeks of the conference session if CE credit is desired. Please note that no evaluations will be accepted after the 2-week deadline, so plan accordingly.
- 3. Access your CE certificate online through the SPPAC User Portal.** In order to view your CE certificate, log into the SPPAC User Portal, click on the "CE Certificate" icon, and select the conference for which you want to generate your CE certificate from the drop-down list. The CE certificate generated from here can be printed or saved as a PDF.

Expanded instructions for using the SPPAC User Portal can be found on the SPP website under the SPPAC Continuing Education tab (<http://www.societyofpediatricpsychology.org/node/684>).

The Society of Pediatric Psychology (Division 54 of the American Psychological Association) is approved by the American Psychological Association to sponsor continuing education for psychologists. The Society of Pediatric Psychology maintains responsibility for this program and its contents.

Please remember: In order for SPP to maintain approval to sponsor continuing education, partial credit cannot be given. Participants must: 1) be present for the entire session; and, 2) complete the associated evaluation form in order to receive CE credit. Participants are responsible for scanning using a self-service kiosk both in and out at the door of each CE session being offered and for submitting their completed evaluation form in a timely fashion (i.e., within 2 weeks of conference adjournment).

For questions or concerns related to continuing education, please speak with Dr. Jennifer Hansen-Moore, SPP Member-at-Large for Continuing Education.

New from GUILFORD PRESS

20%
OFF

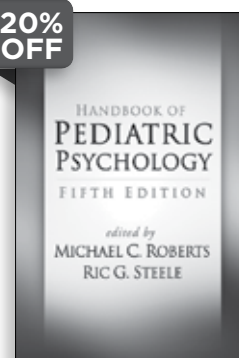

New Edition—A Major Revision!

Handbook of Pediatric Psychology, FIFTH EDITION

Edited by
Michael C. Roberts, PhD, ABPP
Ric G. Steele, PhD, ABPP
—both at University of Kansas,
Lawrence

“The fifth edition of this handbook substantially updates a highly valued classic, with contributions from the top scholars in the field....Content on health care disparities and health systems integration across agencies, communities, and schools adds significant practical utility.”

—Gerald P. Koocher, PhD, ABPP, DePaul University

Sponsored by the Society of Pediatric Psychology, this thoroughly revised volume explores psychosocial aspects of specific medical problems, as well as issues in managing developmental and behavioral concerns that are frequently seen in pediatric settings. It describes best practices in training and service delivery and presents evidence-based approaches to intervention with children and families. All chapters have been rigorously peer reviewed by experts in the field.

April 14, 2017, 7" x 10" Hardcover, 682 Pages, ISBN 978-1-4625-2978-0, \$75.00, **\$60.00**

Save 20% at www.guilford.com with promo code AFSP

LEARNING OBJECTIVES

THURSDAY, MARCH 30

WORKSHOPS 8:30–11:30 a.m.

Ethical Dilemmas in Transgender Health Care

Speakers: Diane Chen, PhD, Laura Edwards-Leeper, PhD, Terry Stancin, PhD, ABPP, & Amy Tishelman, PhD

3 CE

Based on the content of this talk, participants will be able to:

1. Describe diverse presentations of gender identity/gender expression in TGNC children and adolescents.
2. Summarize general approaches to clinical care for TGNC youth across the developmental spectrum and points of controversy.
3. Discuss key ethical dilemmas that emerge in medical and mental health care for TGNC youth.
4. Utilize an ethical decision-making process including clinical, ethical, legal, and risk management considerations to resolve ethical dilemmas related to clinical care for TGNC youth in their own clinical practice.

Advances in Statistical Modeling: Practical Strategies for Addressing Complex Research Questions

Presenters: Rachel Wasserman, PhD, Bridget Armstrong, PhD, David Barker, PhD, Kristoffer Berlin, PhD, Grayson N. Holmbeck, PhD, Bryan Karazsia, PhD, & Betty Lai, PhD

3 CE

COI Statement: Bryan T. Karazsia has received payment for statistical consulting within the past year. No other speakers have conflicts of interest to declare.

Based on the content of this talk, participants will be able to:

1. Create hypotheses that are testable with statistical modeling approaches.
2. Describe which modeling techniques are most appropriate for specific research questions and situations.
3. Apply basic limitations of modeling techniques to critical review of research.

Using Acceptance and Commitment Therapy (ACT) with Adolescents with Medical Conditions: An Advanced Skill-Building Primer

Presenters: Karen E. Weiss, PhD, LP, ABPP, & Staci Martin, PhD, LP

3 CE

Based on the content of this talk, participants will be able to:

1. Identify appropriate ACT therapeutic targets (e.g., cognitive fusion).
2. Discuss various ways to use ACT-consistent techniques to increase psychological flexibility.
3. Demonstrate at least three ACT techniques that can be applied to adolescents with medical conditions.
4. Discuss ways in which ACT processes can lead to health-promoting behavior change.
5. Integrate ACT-consistent techniques into clinical work.

Methods of Using QI Data and Statistical Process Control: The “Quick Start Guide”

Presenters: Richard Brill, MD, FAAP, MCCM, Thomas Bartman, MD, PhD, Richard McClead, MD, MHA, Tammi Young-Saleme, PhD, & Catherine Butz, PhD

3 CE

Based on the content of this talk, participants will be able to:

1. Construct a key driver diagram (“road map”) for their own project, including selection of a specific aim.
2. Compare and contrast how data is used in quality improvement research versus classical research.
3. Explain the difference between data types and measurement types used in quality improvement versus classical research.
4. Identify the components of a run chart used to track progress on quality improvement projects.
5. Develop and implement a QI project in their own clinical practice environment.

WORKSHOPS 1:30–3:30 p.m.

Guidelines for Establishing Integrated Pediatric Behavioral Health Care: Lessons Learned and Recommendations

Presenters: Joseph H. Evans, PhD, Rachel Valleley, PhD, Blake Lancaster, PhD, Shelly Hosterman, PhD, Tawnya Meadows, PhD, & Holly Roberts, PhD

2 CE

Based on the content of this talk, participants will be able to:

1. Describe three business options for establishing pediatric integrated care practices.
2. List three behavioral health issues that commonly present in pediatric primary care.
3. Identify behavioral health protocols that can be applied to address the most common pediatric presenting problems.
4. Develop an action plan for effective and successful integration of BH care into pediatric practice.

Death and Dying: Practical Skills for Working with Bereaved Children and Adolescents

Presenter: Amanda Thompson, PhD

2 CE

Based on the content of this talk, participants will be able to:

1. Explain key strategies for communicating with young children about death and dying.
2. Describe at least three common behavioral and emotional reactions to loss.
3. Develop a plan of action for self-care to implement in their own clinical practice.

WORKSHOPS
1:30–4:30 p.m.

Understanding and Resolving Ethical Concerns That Arise During Clinical Supervision in the Medical Setting

Presenters: Rebecca Hazen, PhD, & Karla K. Fehr, PhD

3 CE

Based on the content of this talk, participants will be able to:

1. List at least three common ethical issues that can arise for trainees in pediatric psychology.
2. Describe three strategies that supervisors can use to improve ethical practices of trainees in the pediatric medical setting.
3. Describe ethical dilemmas that may present within the supervisory relationship with pediatric psychology trainees.
4. Discuss strategies for resolving ethical issues in the supervisory relationship.
5. Describe how supervision strategies for improving ethical practices of psychology trainees can be applied to their own supervisory practices.

Inspiration – Innovation – Commercialization – and Perspiration: Avoiding the Cold Sweats When Your Research Might Be Valuable

Presenters: Jill Chorney, PhD, Chip Sutherland, LLB, Lindsey L. Cohen, PhD, & Melissa Howlett, BSc

3 CE

COI Statement: Lindsey Cohen has served as a consultant for Tusker Medical and received payment within the past year. Jill Chorney has a royalty agreement with Ad-Dispatch for intellectual property related to an MRI preparation game; to date, she has received no payment from this agreement. The other speakers have no conflicts of interest to declare.

Based on the content of this talk, participants will be able to:

1. Describe the similarities and differences between commercialization and traditional research models for innovation.
2. Define commonly used terms in innovation and commercialization (e.g., intellectual property, license, contract, nondisclosure agreement, copyright).
3. Discuss the ethical, practical and legal implications of working in a commercialization model.
4. Identify intellectual property considerations in their own work.

POSTER SESSION

7:00–8:00 p.m.

Poster Session 1

Chairs: Chad Jensen, PhD, & Erica Sood, PhD

1 CE

Based on the content of this talk, participants will be able to:

1. Discuss the latest research findings related to issues in pediatric and child health psychology.
2. Use findings and methodologies presented in the session for their own research in pediatric and child health psychology.
3. Apply findings related to pediatric and child health psychology for their clinical practice.

FRIDAY, MARCH 31

POSTER SESSION
8:00–9:00 a.m.

Poster Session 2

Chairs: Chad Jensen, PhD, & Erica Sood, PhD

1 CE

Based on the content of this talk, participants will be able to:

1. Discuss the latest research findings related to issues in pediatric and child health psychology.
2. Use findings and methodologies presented in the session for their own research in pediatric and child health psychology.
3. Apply findings related to pediatric and child health psychology for their clinical practice.

PLENARY ADDRESS
10:00–11:00 a.m.

Pediatric Integrated Care: Rationale and Progress

Gregory Fritz, MD

1 CE

Based on the content of this talk, participants will be able to:

1. Identify at least three public health, access-to-care, and/or financial issues pushing health care providers toward integrated care.

2. Summarize the evidence available to support using a preventative/integrated care approach to improve health outcomes.
3. Describe how pediatric integrated care is unique relative to existing adult models.
4. Identify at least one specific strategy for overcoming the barriers to integrated care in their own practice.

PROFESSIONAL DEVELOPMENT WORKSHOPS
11:15 a.m.–12:15 p.m.

Establishing and Maintaining a Grant-Funded Program of Research

Presenter: Anthony Spirito, PhD, ABPP

1 CE

Based on the content of this talk, participants will be able to:

1. Identify at least two strategies that can be used to optimize success in maintaining a successful, grant-funded research program.
2. List at least two barriers to a successful, grant-funded research program.
3. Describe how small grants and private foundation grants can be used to support funding hiatuses.
4. Describe how to develop a plan for collecting pilot data to support initiating and sustaining a program of research.

Negotiating for Career Success in Pediatric Psychology

Presenter: Lori Stark, PhD, ABPP

1 CE

Based on the content of this talk, participants will be able to:

1. Identify three aspects of a job offer that may be negotiable.
2. Describe barriers to negotiation.
3. Describe two key components of approaching negotiations.
4. Use a desensitization exercise to decrease fear of rejection in career negotiations.

Becoming a Successful (and Ethical) Clinical Supervisor and Mentor

Presenter: Elissa Jelalian, PhD

1 CE

Based on the content of this talk, participants will be able to:

1. Describe at least two strategies to support the transition from supervisee to supervisor.
2. Discuss the impact of cultural considerations on the supervisory relationship.
3. Identify commonly encountered ethical challenges that can impede effective supervision.
4. Develop a plan for responding to challenging situations in the supervisory relationship.

Publishing 101: Maximizing Your Chances of Success

Presenters: Jennifer Verrill Schurman, PhD, ABPP, Jennifer Shroff Pendley, PhD, Grayson Holmbeck, PhD, & Tonya Palermo, PhD

1 CE

Based on the content of this talk, participants will be able to:

1. Identify at least three common elements that make for a strong pediatric psychology manuscript regardless of the publication outlet.
2. List specific considerations in selecting a publication outlet for academic work.
3. Describe how to tailor a manuscript to the audience and journal (e.g., clinical practice, medical).
4. List three common reasons for manuscript rejection.
5. Organize an effective response to reviews.

CONCURRENT SYMPOSIA 1:45–2:45 p.m.

Unique Collaborations with State, County, and Commercial Payers to Develop Comprehensive Pediatric Psychology Services

Chair: Michael A. Harris, PhD

Discussant: Heather Huszti, PhD

Speakers: Heather Huszti, PhD, Adrienne Alpern, PhD, Michael A. Harris, PhD, & Cindy Kim, PhD

1 CE

Based on the content of this talk, participants will be able to:

1. Identify at least two strategies for approaching ACOs, community mental health agencies or commercial insurers for sustainable funding for psychological services.
2. Name at least three advantages of partnering with community mental health agencies, ACOs or commercial insurers.

3. Develop at least one possible approach for increasing commercial insurance coverage for an existing program at attendee's site.
4. Identify at least two funding mechanisms for sustaining integrated pediatric psychology programs.

Culturally Responsive Assessments and Interventions to Address Pediatric Obesity: A Collaborative Symposium of the Diversity and Obesity SIGs

Chair: Idia B. Thurston, PhD

Discussant: Elizabeth Getzoff Testa, PhD

Speakers: Idia B. Thurston, PhD, Elizabeth Getzoff Testa, PhD, Rebecca C. Kamody, MS, Tiffany Rybak, MS, Marilyn Stern, PhD, & Gina L. Tripicchio, MS, MSED

1 CE

Based on the content of this talk, participants will be able to:

1. Explain how community-based participatory research (CBPR) principles can be effective in research and clinical work with racial/ethnic minority youth with obesity.
2. Describe the process of adapting an existing evidence-based intervention to address the unique needs of Latinos living in rural communities.
3. Discuss how embedding a pediatric obesity treatment program in a single urban primary care clinic can improve child weight outcomes in low-income populations.
4. List key principles to consider in adapting obesity interventions for use with youth of various cultural and ethnic backgrounds.
5. Identify at least two novel ways to implement culturally-responsive interventions for obesity at their home institution.

Provider-Patient Interactions Within Pediatric Medical Care: Challenges and Opportunities for Promoting Collaboration

Chair/Discussant: Laura Smith, PhD, CDE, & Jessica Valenzuela, PhD

Speakers: Laura B. Smith, PhD, CDE, Jessica M. Valenzuela, PhD, Shayna S. Coburn, PhD, Roya Amiriroumand, MA, & Lisa Opiari, PhD

1 CE

Based on the content of this talk, participants will be able to:

1. Identify at least three barriers to teen participation in medical visits.
2. Name at least two aspects of communication during clinic visits that differ by adolescent age.
3. Describe innovative strategies for addressing barriers and increasing provider-patient collaboration in disease management.
4. Discuss evidence-based research strategies for examining provider-patient interactions including qualitative methods, video-based behavior rating systems, and implementation of interventions to promote provider-patient interactions.
5. Implement strategies to assess patient-provider interactions within clinical settings upon return to their home institution.

Outstanding Pediatric Psychology Research by Students and Trainees

Chair/Discussant: Eleanor Mackey, PhD

Speakers: Ashley Marchante, MS, MaryJane Simms, BA, Shelby Wilson, BA, & Katelynn E. Boerner, BSc(Hons)

1 CE

Based on the content of this talk, participants will be able to:

1. Explain the importance of assessing for trauma in pediatric settings that serve low-income communities.
2. Describe the frequency of alcohol-related discussion among adolescents and young adults with type 1 diabetes during routine clinic visits.
3. Describe the role of family factors in the receipt of school-based support services for childhood cancer survivors.
4. Describe how the concept of knowledge translation could be applied to their own research.

DIVERSITY PLENARY ADDRESS

3:00–4:00 p.m.

Racial/Ethnic Disparities in Children’s Health, Health Care, and Mental Health Care, & Community-Based Interventions Which Eliminate These Disparities

Glenn Flores, MD, FAAP

1 CE

Based on the content of this talk, participants will be able to:

1. Describe the current demographics of racial/ethnic minorities in America.
2. Discuss at least two examples of racial/ethnic disparities in children’s health, health care, and mental health care.
3. Explain how community-based interventions can be effective in eliminating racial/ethnic disparities and achieving equity for children and adolescents.
4. Identify at least one specific strategy to provide more equitable care in their own practice setting.

CONCURRENT SYMPOSIA

4:15–6:15 p.m.

Comprehensive, Collaborative, and Integrative Care for Transgender Adolescents

Chair: Laura Edwards-Leeper, PhD

Discussant: Amy Tishelman, PhD

Speakers: Laura Edwards-Leeper, PhD, Karin Selva, MD, Amy Tishelman, PhD, Alyshia Smith, MS, Anastasia Jones, MA, Tabi Evans, MA, Kara Friend, MA, Kelly Haugen, MS, MA, LPC, NCC, Aurora Griffin, MA, & Ariana Greene, MA

2 CE

Based on the content of this talk, participants will be able to:

1. Articulate common mental health concerns found among transgender youth.
2. Describe the role of pediatric psychologists in the integrated care of transgender youth.
3. Explain the goals of the readiness evaluations used with transgender youth.
4. Discuss the medical interventions that are considered with transgender youth.
5. Provide clinical services to transgender youth with a greater appreciation of the challenges faced by this patient population and the range of treatment interventions often considered.

Leveraging Learning Health Registries to Guide Collaborative Research and Practice in Pediatric Chronic Conditions

Chair: Rashmi P. Bhandari, PhD

Discussant: Mark Connelly, PhD

Speakers: Rashmi P. Bhandari, PhD, Jennifer Stinson, RN, PhD, Rachael Coakley, PhD, & Mark Connelly, PhD

2 CE

Based on the content of this talk, participants will be able to:

1. Describe at least three ways that LHS registries inform precision medicine in the treatment of chronic pediatric conditions.
2. Discuss at least three ways that LHSs inform point-of-care clinical interventions.
3. Describe how LHSs can be incorporated into clinical environments to enhance research interventions.
4. Describe three strategies that can help circumvent technical, financial, and systems-based barriers involved in the collection of “big” data.
5. Identify at least one strategy that can be used to optimize success in implementing an LHS registry in their own institution.

Engaging Stakeholders in Pediatric Psychology Research: Partnering with Patients, Healthcare Providers and Communities

Chair/Discussant: Jill Chorney, PhD

Speakers: Jill Chorney, PhD, Nikita Rodrigues, MA, Lindsey L. Cohen, PhD, Stephanie Snow, BSc, & Alvina Rosales, PhD

2 CE

Based on the content of this talk, participants will be able to:

1. Explain how stakeholder engagement can be used to identify directions for research and practice.
2. Describe the role of qualitative methods in eliciting feedback and developing partnerships.
3. List at least two benefits to partnerships around the iterative development of interventions.
4. Identify ethical considerations in conducting research in partnership with patients, communities and health care providers.
5. Better advocate for inclusion of patients, families and communities in the research process at their own institution.

Dissemination and Implementation of Pain and Mental Health Screening in Pediatric Chronic Conditions

Chair: Alexandra Quittner, PhD

Discussant: Tonya M. Palermo, PhD

Speakers: Alexandra Quittner, PhD, Tonya M. Palermo, PhD, Emily F. Law, PhD, Shanna Guilfoyle, PhD, & Jessica Kichler, PhD

2 CE

Based on the content of this talk, participants will be able to:

1. Identify at least three screening tools appropriate for assessment of pain, depression, and anxiety.
2. Describe at least two models for implementing standardized screening for symptoms of pain and psychological distress.
3. Discuss the relationship between symptoms of psychological distress and disease management.
4. Identify one screening strategy that they could implement in their own specialty clinic.

SATURDAY, APRIL 1

POSTER SESSION 8:00–9:00 a.m.

Poster Session 3

Chairs: Chad Jensen, PhD, & Erica Sood, PhD

1 CE

Based on the content of this talk, participants will be able to:

1. Discuss the latest research findings related to issues in pediatric and child health psychology.
2. Use findings and methodologies presented in the session for their own research in pediatric and child health psychology.
3. Apply findings related to pediatric and child health psychology for their clinical practice.

INTERNATIONAL PLENARY ADDRESS 9:15–10:15 a.m.

Implementation Science and Pediatric Psychology: From Evidence to Influence

Christine Chambers, PhD

1 CE

Based on the content of this talk, participants will be able to:

1. List at least three barriers that impede implementation of evidence in pediatric psychology.
2. Describe how implementation science can be used to ensure successful adoption of evidence in pediatric psychology.
3. Develop a plan to promote implementation of evidence in pediatric psychology to knowledge users.

PLENARY ADDRESS 10:30–11:30 a.m.

Finding a Place at the Table: Pediatric Psychology Opportunities in Integrated Care Settings

Terry Stancin, PhD, ABPP

1 CE

Based on the content of this talk, participants will be able to:

1. List at least three reasons why pediatric integrated care approaches are necessary to improve child health outcomes.
2. Describe at least three different models of integrated care delivery.
3. Describe opportunities for pediatric psychologists in the design, implementation, and evaluation of integrated care models.
4. Develop an action plan to promote pediatric psychologists in integrated care, including partnering with physicians and medical organizations.

POSTER SESSION 11:45 a.m.–12:45 p.m.

Poster Session 4

Chairs: Chad Jensen, PhD, & Erica Sood, PhD

1 CE

Based on the content of this talk, participants will be able to:

1. Discuss the latest research findings related to issues in pediatric and child health psychology.
2. Use findings and methodologies presented in the session for their own research in pediatric and child health psychology.
3. Apply findings related to pediatric and child health psychology for their clinical practice.

CONCURRENT SYMPOSIA 2:00–4:00 p.m.

Neurodevelopmental Late Effects in Pediatric Brain Tumor Survivors: From Understanding to Intervention

Chair: Matthew Hocking, PhD

Discussant: Stephen Sands, PsyD

Speakers: Matthew Hocking, PhD, Stephen Sands, PsyD, Lisa Kahalley, PhD, Julie Baran, MS, & Katie A. Devine, PhD

2 CE

Based on the content of this talk, participants will be able to:

1. Discuss neurocognitive outcomes in early survivors of pediatric brain tumors treated with proton radiation compared to other treatments.
2. Describe how functional magnetic resonance imaging techniques can be used to evaluate associations between brain connectivity and neuropsychological outcomes in pediatric brain tumor survivors.
3. Describe the long-term efficacy of CogmedRM on working memory outcomes in pediatric brain tumor survivors.
4. Discuss the feasibility of a school-based, peer-mediated intervention to improve the social competence of childhood brain tumor survivors.

Collaborative Efforts in Treating Youth with Medical and Social Complexity: Systems Autopsies

Chair: Michael A. Harris, PhD

Speakers: Michael A. Harris, PhD, Helen Bellanca, MD, Liz Boileau, David Rozansky, MD, Trisha Wong, MD, & Frances O'Connor, RN

2 CE

Based on the content of this talk, participants will be able to:

1. Explain how providing intensive community-based services to youth with both medical and social vulnerability can improve health, improve care, and reduce costs.
2. Describe the existing gap for medically and social complex youth in the continuum of care established by payers.
3. Describe at least two strategies for negotiating alternative payment models with payers.
4. Explain the importance of identifying and addressing the primary "drivers" of poor adherence and health deterioration in treating youth with medical complexity.
5. List at least three barriers or challenges to collaboration with school nurses around the care of youth with medical complexity.

Resilience Manifested: Examining Strength and Protective Factors in Pediatric Pain

Chair: Lindsey L. Cohen, PhD

Discussant: Laura E. Simons, PhD

Speakers: Lindsey L. Cohen, PhD, Laura Cousins, MA, Rachel Tomlinson, MA, Melanie Noel, PhD, & Laura E. Simons, PhD

2 CE

Based on the content of this talk, participants will be able to:

1. Describe resilience theory in the context of pediatric pain.
2. Explain the importance of assessing and enhancing resilience in pediatric patients with pain and their parents.
3. Discuss different methodological approaches that can be utilized in the examination of resilience in pediatric pain.
4. Describe how resilience factors can be targeted for intervention with youth with pain and their parents.
5. Discuss how to integrate resilience variables in to clinical practice or research focused on youth with pain conditions.

All in the Family: Intergenerational Models Informing Prevention Efforts in Pediatric Populations

Chair: Amanda L. Stone, MS

Discussant: Anna C. Wilson, PhD,

Speakers: Amanda L. Stone, MS, Anna C. Wilson, PhD, Kelvin MacDonald, MD, & Alexandra Bettis, MS

2 CE

Based on the content of this talk, participants will be able to:

1. Explain how parental chronic health conditions may increase risk for adverse physical and mental health outcomes in children.
2. Identify at least two targets for preventive interventions in children of parents with chronic medical conditions.
3. Utilize an intergenerational model to generate novel ideas for future clinical research in pediatric populations.

LISTING OF POSTERS BY SESSION

THURSDAY, MARCH 30—POSTER SESSION 1

7:00–8:00 p.m.

Exhibit Hall

1. **Cognitive Remediation Of Working Memory Deficits In Children With Chronic Health Conditions: Tailoring Cogmed Training To Address Barriers To Adherence**
Kelsey Smith & Jeffrey Schatz
2. **Kidneys, Kids, And Collaborative Quality Care: Novel Interventions In Children’s Healthcare (NICH) For Children With End-Stage Renal Disease**
David V. Wagner, Matthew Heywood, David Rozansky, Nicola Bachman & Michael A. Harris
3. **Examination Of Report Measures Designed To Assess Medication Adherence In Adolescent Transplant Recipients**
Naadira Upshaw, Amanda Suplee, Elizabeth A. Steinberg, Sarah L. Kelly, Pooja Mehta & Cindy Buchanan
4. **Provider Perspectives On Pediatric Cancer Patients’ Long-Term Follow-Up For Care**
David Schwartz, Francesca Bonaduce De Nigris, Nadia Barahmani, Ernest Frugé & Fatih Okcu
5. **Characterizing E-Cigarette Use In Rural Adolescents**
Michael Wilson, Ellen Manegold, Desireé Williford, Paul Enlow, Pamela Murray, Christine Banvard & Christina L. Duncan
6. **Expected Costs And Benefits Mediate The Relation Between Peer Use And Self-Reported Use Of Electronic Cigarettes In Adolescents**
Kristine Durkin, Desireé Williford, Paul T. Enlow, Nicole Pellegrino, Pamela Murray, Christine Banvard & Christina L. Duncan
7. **Healthy Friends’ Acceptance Of A Potential Standardized Messaging To Promote Social Support For Children Diagnosed With A Chronic Illness**
Briana Sowinski, Eva Iglar, Jillian E. Austin, Ellen Defenderfer & W. Hobart Davies
8. **Household Chaos And Mental Health In Youth With Solid Organ Transplants**
Mira Mooreville, Mary Rourke, Christopher Fitzgerald & Debra Lefkowitz
9. **Feasibility And Acceptability Of A Behavioral Intervention Targeting HAART Adherence Among Youth With HIV**
Bethany Means, Megan Wilkins, Aditya Gaur, Nehali Patel & Lisa Ingerski
10. **Associations Between Problem-Solving Skills, Parent-Adolescent Relationship And Communication, And Distress For Adolescents With Cancer**
Adrienne Viola, Alison Taggipinto, Melissa Alderfer, O.J. Sahler & Katie Devine
11. **Grit As A Protective Psychological Factor In Adolescents/Young Adults With Chronic Illness**
Christina M. Sharkey, Dana M. Bakula, Megan Perez, Marissa Baudino, John M. Chaney & Larry L. Mullins
12. **The Impact Of Parent Distress And Parenting Stress On Youth- And Parent Proxy-Report Of Health-Related Quality Of Life In The Families Of Youth With Spina Bifida.**
Colleen Driscoll, Gina Cuevas, Natalie Lawson & Grayson N. Holmbeck
13. **Examining The Bidirectional Influences Of Parental Negativity And Adolescent Externalizing Problems Following Traumatic Brain Injury**
Emily L. Shultz, Stacey Raj, Megan E. Narad, Gerry Taylor, Terry Stancin, Tayna M. Brown, Michael W. Kirkwood & Shari L. Wade
14. **Posttraumatic Growth Among HIV-Seropositive Adolescents And Young Adults**
Kristin Niel, Joyce Hopkins, Arryn A. Guy, Harold Fuentes & Lisa Henry-Reid
15. **Looking Good And Making It Seem Easy: Understanding The Role Of Effortless Perfectionism, Body Image, And BMI In Unhealthy Weight-Control Behaviors Among Female Adolescents And Young Adults**
Lea Travers, Edin Randall, Jenna Shapiro, Alexandra Kirsch, Colleen Conley & Amy Bohnert
16. **Knowledge Improvement Following Camp-Based Intervention Among Youth With Congenital Heart Disease**
Ramanathan Amrita, Kristen Benito, Odessa Holt, Wendy Hadley, Debra Lobato And Lloyd Feit
17. **The Thrive Program: Development Of A Comprehensive Multidisciplinary Program To Enhance The Well-Being Of Pediatric Cardiac Patients, Families, And Staff**
Jami Gross-Toalson & Erin Perez
18. **Safteam: An Innovative Consultation Model To Support Family-Centered Care In Challenging Patient/Provider Relationships**
Laura Judd-Glossy, Eileen Twohy, Anne Penner & Beau Carubia
19. **Interdisciplinary In-Vivo Implementation Of Pediatric Psychology Services During Inpatient Rehabilitation To Re-Initiate Functional Physical Mobility**
Margaret A. Tunney, Courtney R. Porter, Lisa Rones & Cynthia Ward
20. **Pre- And Post-Surgical Neurodevelopmental Evaluations On Infants With Single-Suture Craniosynostosis (SSC) At The Oregon Health And Science University (OHSU): What Is The Ideal Age Of Operation?**
Justin Lee, Laine Atcheson & Mina Nguyen-Driver
21. **The Role Of The Psychologist In A Health Clinic Transition Program**
Laine Atcheson, Harpreet Nagra, Torianne Ipema & Danny Duke

22. **Executive Functioning And Adherence Behaviors Among Youth With Type 1 Diabetes**
Haley Stephens, Harpreet Nagra & Danny Duke
23. **Money Talks: Financial Aspects Of Type 1 Diabetes And Parental Quality Of Life**
Sahar S. Eshtehardi, Viena T. Cao, Brett M. Mckinney, Barbara J. Anderson, David G. Marrero & Marisa E. Hilliard
24. **Psychosocial And Adherence Predictors Of Glycated Hemoglobin (Hba1c) In Adolescents With Type 1 Diabetes**
Ali Calkins, Jonathan Finch, Mark A. Clements & Susana R. Patton
25. **The Feasibility Of Utilizing The Remote Food Photography Method (RFPM) For Families Of Young Children With Type 1 Diabetes (T1D)**
Meredith H. Rose, Randi Streisand, Laura Aronow, Carrie Tully, Corby K. Martin & Eleanor Mackey
26. **Exploring The Role Of Motivational Interviewing In Adolescent Patient-Provider Communication About Type 1 Diabetes**
Laura Caccavale, Alexandra Sova, Rosalie Corona & Melanie Bean
27. **Executive Functioning In Pediatric Youth: A Meta-Analysis Of Youth With Diabetes**
Draycen D. Decator, Melissa L. Engel & Jocelyn S. Carter
27. **Use Of A Parent-Child Feeding Paradigm To Increase Food Acceptance In Young Children With Type 1 Diabetes**
Carrie Tully, Corrine Ahrabi-Nejad, Laura Aronow, Leann Birch, Eleanor Mackey & Randi Streisand
29. **Sleep Hygiene And Sleep Disruption In Youth With Insomnia**
Kelly C. Byars & Tori R. Van Dyk
30. **Do Gender Norms Matter? Exploring The Use Of Preferred Versus Natal Gender Norms With Transgender Youth**
Alex Maixner, Kelsy Newton & Terry Stancin
31. **The Impact Of Stress On Childhood Weight In Mexican-Origin Children And The Moderating Role Of Parental Warmth**
Laura Distel, Dorothy Mcleod, Jaclyn Lennon Papadakis & Catherine Decarlo Santiago
32. **Binge Eating Symptoms Among Children With IDD**
Lilit Hovsepyan, Catherine M. Sanner, Sylvia Herbozo, Cameron L. Neece, & Allyson L. Davis
33. **Working Memory Deficits In Adolescents With And Without Epilepsy Using Multi-Method Assessment**
Angela Combs, Luke Turnier, Caroline Spencer, Sarah Bidwell, Jeffrey Tenney, Rupa Radhakrishnan, Jennifer Vannest, Shari L. Wade & Avani Modi
34. **Precision Medicine In Pediatric Functional Gastrointestinal Disorders: Individualized Assessment For Tailored Treatment**
Jennifer V. Schurman, Christopher C. Cushing, Jennifer B. Blossom & Craig A. Friesen
35. **Long Term Outcomes Of Children With Pediatric Feeding Disorders**
Cindy Kim, Shonda Brown & Jessica Brown
36. **Perceived Stigma, Social Isolation, And Depressive Symptoms In Youth With Inflammatory Bowel Disease (IBD)**
Kaitlyn L. Gamwell, Marissa Baudino, Alexandria Mullins, Dana M. Bakula, John E. Grunow, Noel J. Jacobs, Larry L. Mullins & John M. Chaney
37. **Longitudinal Barriers To Oral Medication Adherence In Adolescents With Inflammatory Bowel Diseases (IBD)**
Jill Plevinsky, Andrea A. Wojtowicz, Steven A. Miller & Rachel Greenley
38. **Managing Non Epileptic Seizures In Oncology Patients: A Case Study**
Joanna Thome Patten
39. **Hydroxyurea Therapy And Disease Complications: A Closer Look At Associations With Nocturnal Enuresis In Youth With Sickle Cell Disease**
Rebecca Rupff, Megan Loew, Justin Williams, Paige Lembeck, Jamilla Griffith, Kathryn Russell & Jerlym Porter
40. **Health Disparities In Psychosocial Risk Screening: Provider Perspectives On Cultural And Language Barriers**
Nicole Ruppe, Maureen Mccafferty, Janet A. Deatrck, Lamia P. Barakat, Martha Askins & Anne E. Kazak
41. **The Role Of Mood In Health-Related Quality Of Life Among Childhood Cancer Survivors**
Margo M. Szabo, Kaushalendra Amatya, Anna George & Kathy Ruble
42. **Stigma, Loneliness And Hospital Outcomes In Adolescents With Sickle Cell Disease**
Sarah Martin, Lindsey L. Cohen, Ifigenia Mougianis, Anya Griffin, Lonnie Zeltzer & Jennie Tsao
43. **The Impact Of Family Demographic Factors On Perceptions Of Helpfulness Of Sibling Support Programs For Families Facing A Childhood Cancer Diagnosis**
Anjali Oberoi, Deborah Berk, Anna Muriel, Jorge Fernandez & Kristin Long
44. **Interactive Effects Of SES, Stress, And Coping On Depressive Symptoms In Mothers Of Children With Cancer**
Heather Bemis, Leandra Desjardins, Lexa Murphy, Kemar Prussien, Kathryn Vannatta, Cynthia Gerhardt & Bruce Compas
45. **Age-Related Differences In Developmental Screening Outcomes Among Young Children With Sickle Cell Disease**
Laura Reinman, Jeffrey Schatz & Kelsey Smith
46. **Preliminary Investigation Of Secondhand Smoke Exposure In Youth With Sickle Cell Disease: Findings From A Primary Care Clinic**
Alayna P. Tackett, Leslie M. Driskill, Eleanor L. Leavens, Alex Wiedenmann, Sunnye Mayes, Ashley Baker, Larry L. Mullins & Theodore L. Wagener
47. **The Impact Of Central Nervous System (CNS) Directed Treatment And Parenting On Child Adjustment In Early Cancer Survivorship**
Adrien Winning, Katianna M. Howard Sharp, Amanda C. Ferrante, Queen Watson, Lexa Murphy, Kathryn Vannatta, Bruce Compas & Cynthia Gerhardt

48. **The Genesis Of A Pediatric School Psychology Role In An Integrated Primary Care Setting: Strategies And Lessons Learned**
Leigh Patterson & Dennis Russo
49. **Funding Mechanisms And Integration In Primary Care: Exploring Relationships And Practice Patterns**
Allison Grennan, Kathryn Hoffses, Andrew R. Riley, Kathryn M. Menousek, Kriston Schellinger, Christina Cammarata & Jason Steadman
50. **Collaborative, Family-Based Care With Outpatient Pediatric Patients: The Vermont Family Based Approach**
Pamela Swift, Masha Ivanova, Deshan Foret, Nalini Flanders, Allison Hall & James Hudziak
51. **Pediatric Residency Training In Assessment And Decision Making Of Behavioral And Developmental Concerns: A Collaborative Training Model**
Erin L. Olufs, Andrew R. Riley, Melissa Weddle, Cindy Ferrell & Kurt A. Freeman
52. **Building Resiliency In Families Of Children With Medical Illness/Injury: A Case Example Of The Families Overcoming Under Stress (FOCUS) Model**
Allison Christian-Brandt, Kanchana Wijesekera & Patricia Lester
53. **Self-Esteem, Quality Of Life, And Emotional Functioning In Children With Congenital And Acquired Limb Loss**
Crystal Quarry, Joan Murray & Erin O'Callaghan
54. **Training Medical Providers To Implement Trauma-Informed Medical Care**
Danielle Weiss, Nancy Kassam-Adams, Flaura Winston, Joel Fein & Meghan L. Marsac
55. **Neuropsychological Sequelae Of Lumbosacral Lipoma: A Case Series Of Two Sisters**
Brent W. Anderson, Amanda M. Rach & Kelli L. Netson
56. **The Relationship Between Functional Disability And Child Depressive Symptoms In Youth With Juvenile Rheumatic Diseases**
Marissa Baudino, Kaitlyn Gamwell, Dana M. Bakula, Christina M. Sharkey, Stephen R. Gillaspay, Amanda Baraldi, Larry L. Mullins & John M. Chaney
57. **"Medicaid And Apms And NICH, Oh My": Collaboration With Payers To Provide NICH To Youth With Medical And Social Complexity**
Samantha Barry, Lena Teplitsky, David V. Wagner, Kim Spiro, Liz Boileau, Brian Rogers & Michael A. Harris
58. **Executive Function And Quality Of Life In Pediatric Obesity**
Marissa A. Gowey, Crystal Lim & David M. Janicke
59. **Emotion Regulation And Parenting As Predictors Of Quality Of Life In Pediatric Transplant Patients**
Nneka Morris Alexander, Jordan Gilleland Marchak & Laura L. Mee
60. **Sociocultural Attitudes Towards Appearance Predict Depressive Symptoms Among Adolescent Females With Obesity**
Carolyn levers-Landis, Marco-Antonio S. Brown, Naveen Uli & Maryann O'Riordan
61. **Exploring The Accuracy Of Parental Perception Of Adolescent Weight Status**
Elizabeth Ruzicka, Katherine Darling, Amy Fahrenkamp & Amy Sato
62. **Child BMI And Income: The Moderating Role Of Time Demands**
Katherine Darling, Amy Fahrenkamp, Elizabeth Ruzicka & Amy Sato
63. **The Summer Healthy-Lifestyle Intervention Program (HIP) For Young Children Who Are Overweight: Results From An Open Trial**
Alexis Garcia, Taylor Landis, Jennifer Melo, Crystal Lim & Paulo Graziano
64. **A Longitudinal Study Of Preschool Relationship Stress And Early Adolescent Emotional Eating And BMI**
Cara C. Tomaso, Katherine M. Kidwell, Chelsea B. Kozikowski, Jennifer Mize Nelson, Kimberly Andrews Espy & Timothy D. Nelson
65. **The Impact Of Executive Functioning On Children's Pain Tolerance During Cold Water Exposure**
Caitlin Thompson, Lynnda Dahlquist, Julia Zeroth & Jessica Hoehn
66. **Where It Really Matters: Associations Between Psychosocial Factors And Patients' Self-Ratings Of Performance And Satisfaction On Self-Selected Activities In Youth With Chronic Pain**
Allison Smith, Kelly Smith, Anna Bruehl, Caitlin Conroy, Edin Randall & Navil Sethna
67. **Virtual Reality For Managing Pediatric Pain And Anxiety During Venipuncture**
Nicole E. Mahrer, Raquel Engilman, Adriana Cabrales, Sloane Fisher, Ezie Nguyen, Arianna Lane, Melody Hannani & Jeffrey I. Gold
68. **The Prevalence Of Adverse Childhood Experiences (Aces) In Pediatric Chronic Pain Patients**
Anjana Jagpal, Keri Hainsworth, Kim Anderson Khan & Susan T. Tran
69. **Feeling The Pressure To Be Perfect: The Role Of Child And Parental Perfectionism On Child Pain, Pain-Related Distress, And Functional Disability**
Edin Randall, Kelly Smith, Victoria Perron, Hannah Robins, Allison Smith, Caitlin Conroy & Laura E. Simons
70. **Dispositional Optimism, Coping Style, And Pain: The Mediating Effect Of Pain Catastrophizing On The Relation Between Dispositional Optimism And Acute Pain Intensity**
Samantha Bento, Wendy Pinder, Lynnda Dahlquist, Julia Zeroth, Emily Steiner & Naomi Parr
71. **Exploring The Mediating Role Of Adolescent Pain Acceptance On Caregiver Psychological Flexibility And Perceived Adolescent Sickle Cell Disease Burden**
Laura A. Cousins, Lindsey L. Cohen, Soumitri Sil, Sarah O. Morris, Anna E. Evans & Julie K. Nguyen
72. **Qualitative Analysis Of The Feasibility Of The Aim To Decrease Anxiety And Pain Treatment (ADAPT) For Youth With Functional Abdominal Pain**
Erin Moorman, Nelson Sarah, Natoshia Cunningham & Michael Farrell

73. **Psychosocial And Family Risk Screening For Youth With Headache In A Pediatric Neurology Clinic**
Emily F. Law & Tonya M. Palermo
74. **Too Psychiatric? An Interdisciplinary Approach To Pain Rehabilitation For An Adolescent With Functional Disability And A Significant Psychiatric History**
Aerial Sheltry, Jason Benincasa, Lindsay Wissman, Suzanne Rybczynski, Merideth Robinson & Cynthia Ward
75. **Predicting Treatment Adherence In Adolescents With Chronic Pain Using Parent Stage Of Change**
Jennifer Lyons, Katherine S. Salamon & Meghan A. Mcgrath
76. **Characterizing Pain Interference In Pediatric Sickle Cell Disease**
Amanda L. Stone, Hannah Boyd, Jasmeka Foster, Melissa Rhodes & Cynthia Karlson
77. **Pain In School: A Brief Report Of Patterns Of Pain-Related School Impairment Among Adolescents With Primary Pain Conditions, Disease-Related Pain, And Pain-Free Peers**
Anna Monica Agoston, Laura Gray & Deirdre Logan
78. **Moving Beyond Self-Efficacy: Physical Activity Cognitions In Adolescence**
Michael Dabney, Carolyn E. Turek & Jocelyn S. Carter
79. **Risk Factors Predicting Family Burden And Activity Restriction In Childhood Food Allergy: A Latent Variable Mixture Modeling (LVMM) Approach**
Patrick Weaver, Kristoffer Berlin & Catherine Peterson
80. **An EMA Study Of Sleep, Affect, And Palatable Food Consumption In Adolescents**
Carolina Bejarano, Amy Noser, Christopher C. Cushing & Alexandra Monzon
81. **Changes In Sleep Patterns In Youth With Sickle Cell Disease: Relations To Pain And Health Care Use**
Cecelia Valrie, Krystal Trout, Nichelle Huber & Beng Fuh
82. **Adolescent Sleep Quality, Anxiety, And Asthma Control: Associations And Between-Group Comparisons**
Andrea Fidler, Casey Lawless, Elizabeth Lefave, Mallory Netz, Andrew Mcconville, Elise Turner & David A. Fedele
83. **The Moderating Effect Of Socioeconomic Status On The Relationship Between Maternal Attention-Deficit/Hyperactivity Disorder (ADHD) And Adolescent Sleep**
Taylor C. Roth, Cara C. Tomaso, Katherine M. Kidwell, Kimberly Andrews Espy, Jennifer Mize Nelson & Timothy D. Nelson
84. **Child Executive Control As A Moderator Of The Longitudinal Association Between Sleep Problems And Subsequent Attention-Deficit/Hyperactivity Disorder Symptoms**
Katherine M. Kidwell, Chelsea Kozikowski, Maren Hankey, Jennifer Mize Nelson, Kimberly Andrews Espy & Timothy D. Nelson

FRIDAY, MAY 31—POSTER SESSION 2

8:00–9:00 a.m.

Exhibit Hall

- | | |
|--------------------------------------------------------------------------------------------------------------------------------------------------------------------------------------------------------------------------------------------------------------------------------------------------------------------------------------------------------------------------------------------------------------------------------------------------------------------------------------------------------------------------------------------------------------------------------------------------------------------------------------------------------------------------------------------------------------------------------------------------------------------------------------------------------------------------------------------------------------------------------------------------------------------------------------------------------------------------------------------------------------------------------------------------------------------------------------------------------------------------------------------------------------------------------------------------------------------------------------------|--------------------------------------------------------------------------------------------------------------------------------------------------------------------------------------------------------------------------------------------------------------------------------------------------------------------------------------------------------------------------------------------------------------------------------------------------------------------------------------------------------------------------------------------------------------------------------------------------------------------------------------------------------------------------------------------------------------------------------------------------------------------------------------------------------------------------------------------------------------------------------------------------------------------------------------------------------------------------------------------------------------------------------------------------------------------------------------------------------------------------------------------------------------------------------------------------------------------------------------------------------------------------------------------------------------------------------------|
| <p>1. Behavior Change Techniques In Pediatric Medication Adherence Smartphone Applications: Content And Usability Analyses
Julia Carmody & Kevin Hommel</p> <p>2. Development Of Psychometric Properties Of The Communication About Medication By Providers-Parent Version
Eva Igler, Ellen Defenderfer, Jill Plevinsky, Rachel Greenley, Lindsey Bugno & W. Hobart Davies</p> <p>3. A Pilot Mobile Health Intervention Aimed To Increase Adherence And Quality Of Life In Pediatric Sickle Cell Disease
Lindsay M. Anderson, Melanie J. Bonner, Jude Jonassaint, Joseph Lunyera & Nirmish Shah</p> <p>4. Depression, Anxiety, And Lung Function Outcomes Following Adherence To Mental Health Recommendations For Adolescents Living With Cystic Fibrosis
Nicholas Hartley, Emily Muther, Jennifer Lindwall & Elin Towler</p> <p>5. Emerging Competence And Adaptation In Young Adults With A Chronic Illness: A Comparison To Healthy Peers
Julia Lamotte, Cyd Eaton, Molly Davis, Ana Gutierrez-Colina, Cynthia Suveg & Ronald Blount</p> <p>6. The Relationship Between Intervention Expectations And Home Practice Compliance Among Adolescents</p> | <p>Participating In A School-Based Mindfulness Intervention
Robert Gibler, Dianna Quach, Emily O'Bryan & Kristen Jastrowski Mano</p> <p>7. Adolescents And Young Adults (AYA) At The End Of Life: Using Voicing My Choices To Enhance Eol Communication And Guide Planning
Sima Zadeh, Lori Wiener & Maryland Pao</p> <p>8. Implementation Of Mental Health Screening In Cystic Fibrosis Centers: Quality Of Life And Impacts On Anxiety
Christina J. Nicolais, Estefany Saez-Flores, Ruth Bernstein, Megan Hamerding, Matthias Salathe & Alexandra Quittner</p> <p>9. A Systematic Review Of Medical Support Interventions For Pediatric Patients With Autism Spectrum Disorder
Kathryn Cantrell, Sarah Coburn, Stephanie Maskell, Jessica Pappagianopoulos & Jolie Straus</p> <p>10. Body Positivity, Satisfaction, And Exercise Are Associated With Lower Depressive Symptoms Among Adolescents And Young Adults With Overweight And Obesity
Caroline Kaufman, Idia B. Thurston, Courtney Maclin-Akinyemi, Robin Hardin, Rebecca C. Kamody & Kristina Decker</p> <p>11. A Systematic Review Of Measures Used To Inform Transition Measurement Development: A SMART PROMIS
Michelle Brenes, Jessica M. Valenzuela, Lori Crosby & Alexa Beck</p> |
|--------------------------------------------------------------------------------------------------------------------------------------------------------------------------------------------------------------------------------------------------------------------------------------------------------------------------------------------------------------------------------------------------------------------------------------------------------------------------------------------------------------------------------------------------------------------------------------------------------------------------------------------------------------------------------------------------------------------------------------------------------------------------------------------------------------------------------------------------------------------------------------------------------------------------------------------------------------------------------------------------------------------------------------------------------------------------------------------------------------------------------------------------------------------------------------------------------------------------------------------|--------------------------------------------------------------------------------------------------------------------------------------------------------------------------------------------------------------------------------------------------------------------------------------------------------------------------------------------------------------------------------------------------------------------------------------------------------------------------------------------------------------------------------------------------------------------------------------------------------------------------------------------------------------------------------------------------------------------------------------------------------------------------------------------------------------------------------------------------------------------------------------------------------------------------------------------------------------------------------------------------------------------------------------------------------------------------------------------------------------------------------------------------------------------------------------------------------------------------------------------------------------------------------------------------------------------------------------|

12. **Gender And Weight-Based Variations In Adolescent Stress Reactivity**
Maren Hankey, Jessica K. Pogue, Taylor C. Roth, Jennifer Mize Nelson, Kimberly Andrews Espy & Timothy D. Nelson
13. **Patient Navigation: A Qualitative Study Of Barriers In The AYA Population**
Kayla Larosa, Courtney Lynn & Marilyn Stern
14. **Developing A Transition Program In A Pediatric Renal Transplant Clinic**
Jordan Wade, Haley Stephens, Suzanne Billings & Kurt A. Freeman
15. **Multi-Level Model Of Self-Concept, Depression, And Parent-Child Attachment In Pediatric Chronic Illness**
Natacha Emerson, Holly E. R. Morrell, Cameron L. Neece, Daniel Tapanes & Brian Disterlberg
16. **Results Of Mental Health Screening Among Young Heart Transplant Recipients**
Nicole Dempster, Deipanjan Nandi, Christina M. Phelps, Lauren Fisher, Heather Missler, Debbie Malloy, Keisha Tully, Tina Cole, Julie Miller, Kirby Carpenito, Emily Wheat & Robert Gajarski
17. **Fathers' Experience Of Raising A Child With A Critical Congenital Heart Defect**
Linda G. Mcwhorter
18. **From The Ground Up: Formation And Implementation Of A Consultation-Liaison Service**
Christopher Min & Heather Huszti
19. **Characteristics Of Services Provided By Inpatient Psychiatry/Psychology Consultation/Liaison Across A 3-Year Period At A Regional Children's Hospital**
Sarah Wu, Erin N. Schoenfelder, Brent Collett, Freda F. Liu, Ian Kodish & Cynthia Flynn
20. **Self-Regulation, Sleep Quality, And Diabetes Management In Adolescents With Type 1 Diabetes.**
Sara Turner, Cynthia Berg & Deborah Wiebe
21. **Longitudinal Relations Among Health-Related Quality Of Life, Psychological Concerns, Diabetes-Specific Stress, And Glycemic Control Among Primarily Low-Income Adolescents With Type-1 Diabetes**
Kimberly Klages, Kristoffer Berlin, Gabrielle Banks, Tiffany Rybak, Katherine Semenkovich, Tawana Smith, Ramin Alemzadah, Alicia Diaz-Thomas & Angelica Eddington
22. **Impact Of Physical Activity And Sedentary Behavior On Diabetes-Specific Health-Related Quality Of Life: The Intersection Of Medicine And Psychology**
Marta Lynn Pardo, James W. Varni & William Rae
23. **Parent-Youth Agreement On Diabetes-Related Distress: Associations With Type 1 Diabetes (T1D) Strengths And Glycemic Control**
Anthony T. Vesco, Marissa A. Feldman, Meredyth A. Evans & Jill Weissberg-Benchell
24. **Cgms, Accelerometers, And Fitbits, Oh My! : Feasibility Of Multiple Wearable Technologies In Research With Young Children With Type 1 Diabetes (T1D)**
Sarah Breen, Laura Aronow, Carrie Tully, Celia Henderson, Eleanor Mackey & Randi Streisand
25. **Punitive Parenting Style Predicts Poorer Glycemic Control In Youth With New Onset Type 1 Diabetes**
Jonathan Finch, Amy E. Noser, Jacqueline J. Shea, Jennifer Raymond, Mark A. Clements & Susana R. Patton
26. **Take Your Best Guess: Using Error Grid Analysis To Measure Blood Glucose Estimation Accuracy In Adolescents With Type 1 Diabetes**
Natalie E. Benjamin & Astrida Kaugars
27. **Age At Diagnosis Of Type 1 Diabetes And Glycemic Control In Children And Adolescents**
Carolyn E. Turek, Federico Guerriero, Jocelyn S. Carter & Tina Drossos
28. **The Diabetes Family Conflict Scale Short Form: Reliability And Validity In Youth With Type 1 Diabetes And Their Caregivers**
Katherine Semenkovich, Kristoffer Berlin, Rachel Ankney, Kimberly Klages, Tiffany Rybak, Gabrielle Banks, Tawana Smith, Alicia Diaz-Thomas, Ramin Alemzadah & Angelica Eddington
29. **Developing A Multidimensional, Multi-Rater Measure Of Transition To Adult Care Outcomes For Young Adults With Type 1 Diabetes**
Jessica Pierce, Karen J. Aroian, Elizabeth Schifano, Amy Milkes, Anthony Gannon & Tim Wysocki
30. **Brief Behavior Intervention Program For Culturally Diverse Families Of Children With Chronic Health Conditions**
Rachel Fein, Petra Duran & Marni Axelrad
31. **Depressive Symptoms, Neighborhood Stress, And Asthma Control In Urban Children**
Gillian G. Leibach, Samantha Miadich & Robin Everhart
32. **It Takes A Village: Collaborative Application Of Novel Interventions In Children's Healthcare (NICH) For Children With Failure To Thrive**
Clarissa Camarillo, David V. Wagner, Jonah Harris, Kristen Leadem, Jimmie Ogden, Brian Rogers, Darren Janzen, David Spiro, Kim Spiro & Michael A. Harris
33. **Attitudes Toward School And Teachers May Influence Health-Related Quality Of Life In Children With Epilepsy**
Luke Turnier, Brooke Hater, Lauryn Urso, Angela Combs, Aanchal Seth, Taelor Mccarthy, Katherine Junger, James W. Varni, Janelle Wagner, Gigi Smith, Tanja Kellermann, Heather Huszti, Lauren Barrett, Grace Mucci, Shanna Guilfoyle, Aimee Smith & Avani Modi
34. **Physiological Reactivity As A Risk Factor For Psychosocial Difficulties In Pediatric Patients With Inflammatory Bowel Disease**
Bonney Reed-Knight, Grace Cushman, Lindsay Rosenthal, Sharon Shih & Meredith Bishop
35. **Effects Of Gender And Stress On The Diet Of Adolescents With Inflammatory Bowel Disease**
Jessica Kickel, Laura Mackner, Michael Bailey & Wallace Crandall
36. **School Functioning In Adolescents With Inflammatory Bowel Disease (IBD): Demographic And Disease Correlates**
Samantha Carreon & Rachel Greenley

37. **Bag'n It: Ostomy-Related Distress In Youth With Inflammatory Bowel Disease**
Maggie Stoeckel & Michael A. Harris
38. **Assessing Experiential Avoidance In Parents Of Children With Cancer: Validation Of The Parental Acceptance And Action Questionnaire**
Rachel Kentor, Leah Mcdiarmid, Megan Perez, Lauren Ostarello, Flora Hoodin, Michelle Byrd, Kristin Kullgren & Gregory Yanik
39. **Development Of A Screening Module To Assess Psychosocial Risk Among Siblings Of Children With Cancer**
Emily M. Pariseau, Andrea A. Chu, Anna Muriel, Anne E. Kazak & Melissa Alderfer
40. **Academic And Neurocognitive Screening For Children With Sickle Cell Disease**
Jeffrey Karst, Meghan Miller, Newby Robert & John Paul Scott
41. **Extended Family Support For Siblings Of Children With Cancer In Hispanic And Non-Hispanic Families**
Emily M. Pariseau, Marina Ritchie, Andrea A. Chu, Anna Muriel & Kristin Long
42. **The Effects Of Age And Gender On Illness Concept In Siblings Of Children With Cancer: A Qualitative Analysis**
Alex E. Keller, Emily M. Pariseau, Andrea A. Chu, Anna Muriel & Kristin Long
43. **Emotional And Social Functioning In Youth With Sickle Cell Disease**
Paige Lembeck, Justin Williams, Kathryn Russell, Rebecca Rupff, Jamilla Griffith, Megan Loew & Jerlym Porter
44. **Promoting Sleep Hygiene And Physical Activity On A Pediatric Inpatient Oncology Unit: The Role Of Health Care Providers**
Sherilynn Chan, Christina Caiozzo, Ellen Defenderfer, Jeffrey Karst, Kristin Bingen & Jennifer Hoag
45. **Internalizing Symptoms In Mothers And Associations With Later Family Functioning And Depressive Symptoms In Siblings After A Child's Death From Cancer**
Amanda C. Ferrante, Queen-Erin Watson, Adrien Winning, Katianne M. Howard Sharp, Maru Barrerra, Diane Fairclough, Mary Jo Gilmer, Terrah Foster Akard, Bruce Compas, Kathryn Vannatta & Cynthia Gerhardt
46. **The Roles Of Peer Acceptance And Victimization On Academic Achievement In Pediatric Brain Tumor Survivors**
Mary Hagan, Jennifer Monti, Kathryn Balistreri, Cynthia Gerhardt, Maru Barrerra, Andrea Patenaude & Kathryn Vannatta
47. **Psychometric Properties Of PROMIS® Pain Interference And Fatigue Assessments In Adolescents And Young Adults With Sickle Cell Disease**
Aimee K. Hildenbrand, Charles T. Quinn, James L. Peugh, Maria T. Britto & Lori Crosby
48. **Child Behavioral Health Treatment Initiation And Wait Time: How A Primary Care And Hospital-Based Clinic Compare**
Andrew Cook, Teryn Bruni & Blake Lancaster
49. **Effects Of Telehealth On Quality Of Life For Children With Chronic Illness**
Clara Ko, Kristin Niel, Jason Grey Faulkenberry, Liz Bayes Santos, Judy Schaechter & Elizabeth Pulgaron
50. **Examining Early Childhood Adversity And Attendance At Preventative Care Visits For Families Involved In A Pediatric Primary Care Intervention**
Catherine Wolcott, Melissa Buchholz, Amelia Ehmer & Ayelet Talmi
51. **Psychodiagnostic Assessments In Integrated Primary Care: Filling A Service Gap And Promoting Primary Care Team Collaboration**
Kim Reynolds, Caitlin Rasplica, Erin L. Olufs & Robin Willins
52. **Understanding Healthcare Professionals' Beliefs On Traumatic Stress Disorder**
Amanda A. Bowling, Alexandra L. Fisher, Ashlee M. Von Buttlar, Jordan Dell, Leeann M. Christie & Lauren Gambill
53. **Implementation Of An Acquired Brain Injury Protocol To Standardize Care And Promote School Re-Entry In A Day Rehabilitation Setting**
Shana Wilson, Nicole Swain, Sarah Brown, Mary Beth Doerr, Maria Houston, Christopher Najarian & Chelsea Weyand
54. **Organized Activity Involvement And Psychosocial Outcomes Among Pediatric Burn Survivors: A Qualitative Study**
Desireé Williford, Christina L. Duncan, Ellen Manegold, Sarah Addicks, Cameron Ford, Laurel Brabson, Brittany Liebsack, Linda Leonard, Lourdes Castanon & Ariel Aballay
55. **Parenting Stress As A Predictor Of Maternal Sensitivity: Comparisons Of Deaf Children With Cochlear Implants And Hearing Peers**
Zabin S. Patel, Michael Hoffman & Alexandra Quittner
56. **Influence Of IQ On Academic Achievement In Youth With Spina Bifida: Examining Self-Advocacy Skills As Potential Mediators**
Alexa Stern, Laura Acevedo, Sonia Ramirez & Grayson N. Holmbeck
57. **Preliminary Validation Of The English Version Of The Gilles De La Tourette Syndrome-Quality Of Life Scale For Children And Adolescents**
Lindsay Rosenthal, Ana Gutierrez-Colina, Julia Lamotte, Cyd Eaton, Emily Ivey, Patricia Kardon & Ronald Blount
58. **Disclosure Of Chronic Pediatric Conditions: Evaluating Parental Autism Disclosure Strategies**
Ratka Galijot, Jillian E. Austin & W. Hobart Davies
59. **Predictors Of Adolescent BMI Percentile: The Impact Of Daytime Sleepiness And Media Use On BMI**
Lindsey Elliott & Aaron Fobian
60. **The Development Of A Pediatric Bariatric Surgery Protocol Using An Ecological Framework**
Kelsie Hendrickson & Jasmin Searcy
61. **Preliminary Findings Of The Childhood Health And Asthma Management Program (CHAMP)**
Mallory Netz, David A. Fedele, Casey Lawless, Alyssa Fritz, Elise Turner, David M. Janicke, Elizabeth Mcquaid, Dawn Baker & Mutasim Abu-Hasan

62. **A Multisite 2-Year Follow-Up Of Psychopathology Prevalence And Correlates For Adolescents With Severe Obesity Who Did/Did Not Undergo Bariatric Surgery**
Sanita Hunsaker, Beth Garland, Dana Rofey, Jennifer Reiter-Purtill, James Mitchell, Anita Courcoulas, Todd Jenkins & Meg H. Zeller
63. **Utilizing A Mixed Method Approach To Understand Health And Lifestyle Behaviors In Offspring Of Mothers With Severe Obesity Who Undergo Bariatric Surgery**
Meg H. Zeller, Shannon M. Robson, Roohi Kharofa, Mary Beth Mccullough, Lori Crosby, Lisa West-Smith, Anita Courcoulas, Sanita Hunsaker, Taylor Howarth, Sara Comstock & Jennifer Reiter-Purtill
64. **Interactive Family And Peer Processes In Adolescents With Chronic Pain**
Alexandra Ross, Rashmi P. Bhandari & Amanda B. Feinstein
65. **Characterizing Pediatric Chronic Pain Patients With And Without A Physical Precipitant**
Traci M. Kennedy, Jennifer Sherker, Kimberly Miller, Bernadette Lewcun & David D. Sherry
66. **Differences Between Clinical And Community Chronic Pain Samples In School Absence, School Performance And Functional Disability**
Alix Mclaughlin, Lauren E. Harrison & Catherine Peterson
67. **The "Parents As Coping Coaches" Intervention: Preliminary Support For The Role Of Distress Tolerance In Reducing Caregiver Burden Among Parents Of Adolescents With Chronic Pain**
Victoria Galica, Jessica W. Guite & Beth Russell
68. **Anxiety And Disability In Pediatric Chronic Pain: Relationships Between Youth, Mother, And Father Reports**
Susan T. Tran, Kristen Jastrowski Mano, Kim Anderson Khan, W. Hobart Davies & Keri Hainsworth
69. **Intensive Interdisciplinary Day Rehabilitation For Patients With Chronic Pain**
Lara Jones, Camara Murphy, Beverly Shieh, Merideth Robinson, Eve Nguyen & Cynthia Ward
70. **Dispositional Mindfulness And Pain Tolerance: Sex Differences In Healthy School-Age Children**
Wendy Pinder, Lynnnda Dahlquist, Samantha Bento, Naomi Parr, Emily Steiner & Julia Zeroth
71. **Effect Of Brief Biofeedback Program On Functioning And Healthcare Utilization**
Lauren Garbacz, Anthony Castillo & Catherine Butz
72. **Multiple Pain Sites In Youth With Chronic Pain: Impact Of Cumulative Load**
Molly C. Basch, Erika Chow, Deirdre Logan, David Borsook, Neil Schechter & Laura E. Simons
73. **Clarification Of Discrepant Sleep Reporting In Adolescents With Chronic Pain: A Case Series**
Merideth Robinson, Beverly Shieh, Marissa A. Smith, Valerie Paasch & Cynthia Ward
74. **Parental Factors Impact Child Outcomes In The Context Of Pediatric Acute Musculoskeletal Pain**
Pari Faraji, Anna C. Wilson & Amy Lewandowski. Holley
75. **The Implementation Of A Freely Available Smartphone App To Assess Pain And Its Impact In Children With Cancer**
Perri Tutelman, Christine T. Chambers, Jennifer Stinson, Jennifer Parker, Hayley Stinson, Melanie Barwick, Fiona Campbell, Conrad Fernandez, Karen Irwin, Lindsay Jibb, Paul Nathan & Holly Witteman
76. **Implementing Objective Strength Testing To Evaluate The Efficacy Of Interdisciplinary Graded Exposure Treatment In Youth With Unilateral Chronic Pain**
Corey A. Kronman, Justin A. Beebe, Eileen Li, Cora Mukerji, Ellen Mcginnis, Christine Sieberg, Molly C. Basch & Laura E. Simons
77. **Parent Chronic Pain And Mental Health Impact Catastrophizing About Their Child's Pain**
Lauren M. Fussner, Cathleen Schild, Amy Lewandowski. Holley & Anna C. Wilson
78. **Parent Perceptions Of Adolescent Mood: Correlations With Health And Daily Activity**
Casey Winterson, Pamela Swift, Stephanie Day, Meghan Schreck, Jackie Ellis, Sam Raszka, Amanda Pelkey, Jeremy Sibold & James Hudziak
79. **A Cross-Lagged Model Of Bio-Behavioral And Family Processes In Pediatric Asthma**
Nour Al Ghriwati & Marcia Winter
80. **Sleep And Affect: Does Getting More Sleep Really Improve Mood?**
Alexandra Monzon, Christopher C. Cushing, Tarrah Mitchell & Carolina Bejarano
81. **Sleep Disturbance, Quality Of Life, And Asthma Status In Youth**
Rachel Sweenie, Casey Lawless, Marie L. Chardon, Julia K. Carmody, David M. Janicke & David A. Fedele
82. **A Longitudinal Study Of Early Life Stress In Preschoolers Predicting Sleep Problems In Early Adolescence**
Chelsea B. Kozikowski, Taylor C. Roth, Cara C. Tomaso, Katherine M. Kidwell, Jennifer Mize Nelson, Kimberly Andrews Espy & Timothy D. Nelson
83. **Using Interdisciplinary Collaboration And Actigraphy To Address Sleep Difficulties That Co-Occur With Attention-Deficit/Hyperactivity Disorder**
Ellen Henning, Cyd Eaton, Janet Lam & Valerie Paasch
84. **Sleep And Psychosocial Adjustment In Pediatric Patients Awaiting Transplantation**
Ana Gutierrez-Colina, Grace Cushman, Lindsay Rosenthal, Cyd Eaton, Colleen Keeler, Jennifer L. Lee, Bonney Reed-Knight, Kristin Loiselle Rich, Laura L. Mee & Ronald Blount

SATURDAY, APRIL 1—POSTER SESSION 3

8:00–9:00 a.m.

Exhibit Hall

1. **Are Personality Characteristics Associated With Adherence To Medical Regimen For Children With Cystic Fibrosis?**
Amy R. Goetz, Kathrin Herzhoff, Cruz A. Munoz & Danita I. Czyzewski
2. **When Being In The Top 5% Is Reason For Concern: Youth With Medical And Social Complexity**
Mallori Jirikovic, David V. Wagner, Samantha Barry, Brian Rogers, Ariel Back & Michael A. Harris
3. **In-Clinic Adolescent Peer-Group Support For Engagement In Sub-Saharan Africa: A Feasibility And Acceptability Trial**
David Barker, Anthony Enimil, Omar Galárraga, Larry Brown & Awewura Kwara
4. **Does Inhibitory Control Moderate The Association Between Dietary Restraint And Intake Of Energy-Dense Foods In Adolescents**
Adelyn Cohen, Kaitlyn Egan, Rachel Kantor & Christine Limbers
5. **Evaluation Of The Factor Structure Of The Hospital Anxiety And Depression Scale In Adolescents And Young Adults With Cystic Fibrosis**
Estefany Saez-Flores, Niza Tonarely, David Barker & Alexandra Quittner
6. **Evaluating Electronic Personal Health Record Use Among Young Adult Survivors Of Childhood Cancer**
Jordan Gilleland Marchak, Rebecca W. Lewis, Brooke Cherven, Jennifer L. Lee, Lillian Meacham & Ann Mertens
7. **Identification Of Subscales Within The Health Conditions Attitudes Questionnaire: Measurement Of Teacher Experience And Beliefs About Common Health Conditions**
Aimee W. Smith, Beth Wildman & Jeannette Iskander
8. **The Longitudinal Impact Of A Family-Based Risk Intervention On Observational And Self-Reports Of Sexual Communication.**
Wendy Hadley, David Barker, Amy Hughes Lansing, Larry Brown, Geri Donenberg, Ralph Diclemente & Elizabeth Tutu
9. **Multicultural Integrated Kidney Education (MIKE) Program And Pacific University: A Collaborative Partnership To Address Pediatric Chronic Disease**
Susan Li, Alexandra Schmidt, Emma Cohan, Amia Huang & Cheryl Neal
10. **Participation In Individuals With Pediatric-Onset Spinal Cord Injury: The Examination Of Social Integration**
Andrea A. Wojtowicz, Steven A. Miller, Lawrence Vogel, Rachel Greenley & Kathy Zebracki
11. **Reactions To Different Physician Pain Dismissal Topographies**
Amy C. Lang, Eva Iglar, Ellen Defenderfer, Julia Uihlein, W. Hobart Davies & Chasity Brimeyer
12. **The Teen ADHD Workshop To Increase Treatment Engagement: 6 Week Outcomes Of A Randomized Pilot Trial**
Erin N. Schoenfelder, Tyler Sasser, Aurora G. Fife & Erin G. Underbrink
13. **Collaborative Development Of An Innovative Young Adult Pain Rehabilitation Program And Initial Outcomes**
Michele Tsai Owens, Cynthia Harbeck-Weber, Michele Evans, Connie Luedtke, Emily Dresher, Andrea Eickhoff & Eleshia J. Morrison
14. **Fertility Preservation For Transgender Adolescents: A Retrospective Chart Review**
Diane Chen, Lisa Simons, Emilie K. Johnson & Courtney Finlayson
15. **The Relationship Between Worry And Posttraumatic Growth In Adolescent And Young Adult Cancer Survivors**
Glynnis A. Mcdonnell, Alice W. Pope, Tammy A. Schuler & Jennifer S. Ford
16. **“Hope Is So Fragile”: Parent Perspectives In The Multidisciplinary Care Of Children With Single Ventricle Heart Disease.**
Katie Zaki, Sarah L. Kelly, Jeffrey Darst & Michael Dimaria
17. **Measuring Provider Knowledge, Desire To Use Skills Learned, And Perceived Confidence In Using Strategies Following A Motivational Interviewing Training Workshop At A Children’s Hospital.**
Wade C. Mcdonald, Elizabeth C. Victor, Ana F. El-Behadli & Melissa A. Faith
18. **Pediatric Provider’s Perceptions Of Working With Youth With Somatic Symptom And Related Disorders: Opportunities For Pediatric Psychologists To Collaborate On Physician Education**
Dana Albright, Cook Robin, Laura Donohue, Steven Leber, Nasuh Malas & Kristin Kullgren
19. **Evaluation Of An Inpatient Rehabilitation Protocol For Gait Abnormalities In Pediatric Patients With Conversion Disorder**
Catherine Butz, Cindy Iske, Michelle Miller, Chrissie Koterba & Winnie Chung
20. **Factor Structure of the Pediatric Inventory for Parents (PIP) in Fathers of Children with Type 1 Diabetes**
Christine Limbers, Ashley Teasdale, Maddie Larson & Shawn Latendresse
21. **Examining Youth And Caregiver Psychological Flexibility In Relation To Diabetes-Specific Family Conflict, Quality Of Life, And Glycemic Control**
Tiffany Rybak, Kristoffer Berlin, Kimberly Klages, Gabrielle Banks, Tegan Reeves, Katherine Semenkovich, Tawana Smith, Ramin Alemzadah, Alicia Diaz-Thomas & Angelica Eddington
22. **Parental Depression Is Associated With Maintenance Of Daily Diabetes-Specific Parenting Distress In The New-Onset Period**
Susana R. Patton, Amy E. Noser, Arwen M. Marker, Jennifer Raymond, Jacqueline Shea & Mark A. Clements

23. **Acceptability And Feasibility Of Using Parent Coaches To Support Parents Of Young Children With Type 1 Diabetes**
Caitlin Shneider, Carrie Tully, Rachel Sweenie, Marisa E. Hilliard, Maureen Monaghan & Randi Streisand
24. **Parental Feeding Styles And Glycemic Control In Families Of Children With Type 1 Diabetes**
Rebecca Hazen, Melissa Rafferty, Christin Seher & Carolyn levers-Landis
25. **Effectiveness Of Behavioral Family Systems Therapy For Adolescents With Type 2 Diabetes: Medical And Adherence Outcomes**
Lisa M. Buckloh, Amy Milkes, Tim Wysocki, Robbin Seago, Larry A. Fox & Miles Yu
26. **Self-Management Among Ethnic Minority Adolescents With Type 1 Diabetes**
Meg C. Nicholl, Jessica M. Valenzuela, Keith Lit, Christian Delucia, Alan Delamater, Jennifer Shroff Pendley & Dennis Drotar
27. **The Relation Between Parental Maladaptive Coping And Treatment Adherence Among Adolescents With Diabetes Mellitus: Evaluating Parent And Teen Emotional Distress, Family Dynamics, And Teen Coping As Mediators**
Jenna Shapiro & Tina Drossos
28. **Why Can't You Take Care Of Your Diabetes? Differences In Parent And Child Perceptions Of Diabetes Care.**
Christina Rouse, Heather Yardley, Kristen Trott & Nicole Dempster
29. **Application Of A Cohort Sequential Design To Examine Outcomes Of Decision Making Involvement In Youth With Type 1 Diabetes**
Victoria A. Miller & Abbas Jawad
30. **Understanding Disparities In Listing For Pediatric Solid Organ Transplant**
Elizabeth A. Steinberg, Naadira Upshaw, Amanda Suplee, Sarah L. Kelly, Pooja Mehta & Cindy Buchanan
31. **A Multi-Component Telehealth Treatment Program For Parents Of Children With Pediatric Feeding Problems: A Case Study.**
Racheal Clark & Aaron J. Fischer
32. **Parental Perceptions Of Food Allergy Severity: An Examination Of Child Risk**
Alana Resmini Rawlinson, Megan Schaefer, Maryjane Simms, Caroline Nevin, Sophie-Leigh Roth, Elizabeth Brestan-Knight & Wendy Gray
33. **The Role Of Executive Functioning In Psychosocial Health Of School-Aged Children With Epilepsy**
Brooke Hater, Katherine Junger, James W. Varni, Janelle Wagner, Gigi Smith, Tanja Kellermann, Heather Huszti, Lauren Barrett, Grace Mucci, Lauryn Urso, Angela Combs, Aanchal Seth, Luke Turnier, Taelor Mccarthy, Shanna Guilfoyle, Aimee Smith & Avani Modi
34. **The Impact Of Disease Characteristics On Readiness For Transition In Adolescents And Young Adults With Inflammatory Bowel Disease**
Kaitlin Proctor, Jamie Travis, John E. Grunow & Noel J. Jacobs
35. **Eating Pathology In Youth With Celiac Disease In A Primary Care Setting**
Jessica Edwards George, Meredith Dove, Rachel Rodgers, Joan Hanania, Rachel Berry, Melissa Giblin, Debra Franko, Neal Leleiko & Debra Lobato
36. **Predicting Quality Of Life Of Youth Scheduled For An Esophagogastroduodenoscopy**
Mary Lynch, Rachel Marcus & Reed Dimmitt
37. **The Rigorous Development And Evaluation Of A Text Bank: A Trial Of Adolescent And Young Adult Survivors Of Childhood Cancer As An Example**
Lisa A. Schwartz, Alexandra Psihogios, Elizabeth S. Ver Hoeve, Christine Hill-Kaysar, Eliana Butler, Serena Gupta, Lamia P. Barakat, Emily Fredericks, Nadia Dowshen, Sandra Amaral, Linda Fleisher, Wendy Hobbie, Jill Ginsberg, Linda Jacobs, Elicia Wartman & Dava Szalda
38. **The Impact Of Internalizing Symptoms On The Relationship Between Pain And Social Functioning In Youth With Sickle Cell Disease.**
Brianna Knox, Nichelle Huber, Krystal Trout & Cecelia Valrie
39. **Parent Personality Predicts Psychosocial Distress In Parents Of Children Who Have Completed Treatment For Cancer**
Jennifer L. Lee, Rebecca Williamson, Danielle Edmonds, Ann Mertens & Jordan Gilleland Marchak
40. **Sickle Cell Disease-Related Worry And Psychological Functioning: Exploring The Protective Role Of Family Functioning**
Justin Williams, Paige Lembeck, Kathryn Russell, Rebecca Rupff, Jamilla Griffith, Megan Loew & Jerlym Porter
41. **Prospective Influence Of Family Functioning On Psychosocial Health-Related Quality Of Life In Pediatric Brain Tumor Survivors At The Conclusion Of Tumor-Directed Therapy**
Julie Baran, Lauren F. Quast, Peter Phillips, Anne E. Kazak, Yimei Li, Lamia P. Barakat & Matthew Hocking
42. **The Experience Of Sibling Bone Marrow Donation: A Longitudinal Study**
Christina Caiozzo, Sherilynn Chan, Ellen Defenderfer, Jeffrey Karst, Kristin Bingen & Jennifer Hoag
43. **The Impact Of Parent Pain Catastrophizing On Depressive Symptoms In Youth With Sickle Cell Disease.**
Alana Goldstein-Leever, Soumitri Sil, Lindsey L. Cohen & Carlton Dampier
44. **Longitudinal Examination Of Parenting-Efficacy Following Pediatric Stem Cell Transplant**
Rachel Tillery, Sarah Drake, Suzanne Berger, Stella M. Davies & Ahna L.H. Pai
45. **Psychosocial Functioning Of 2-5 Year Old Children Treated For Cancer**
Lauren E. Cox, Ansley E. Kenney, Jennifer Ehrentraut, Niki Jurbergs, Andrew E. Molnar & Victoria W. Willard

46. **Neurocognitive And Neurological Outcomes In Children, Adolescents And Young Adults With Sickle Cell Disease (SCD) Who Have Undergone Familial Haploidentical (FHI) Allogeneic Stem Cell Transplantation**
Suzanne Braniecki, Mitchell Cairo, Julie-An Talano, Theodore B Moore, Rona Weinberg, Carolyn A Keever-Taylor, Brenda Grossman, Lee Ann Baxter-Lowe, Susan Parsons, Erin Morris, Phyllis Brand, Sandra Fabricatore, Janet Ayello, Mildred Semidei-Pomales, Carmella Van De Ven, Cori Abikoff, Shalini Shenoy & Robert Mckinstry
47. **Integrated Well Visits In Pediatric Primary Care: A Collaborative Approach To Prevention**
Cheyenne Hughes-Reid, Meghan Walls & Meghan Lines
48. **Quality Of Life Improvements Following Treatment In A Family-Based, Integrated Care, Pediatric Psychology Day Program**
Margaret Mannix, Christopher Houck, Diane Dermarderosian, Michelle Rickerby & Jack Nassau
49. **Parent Compliance With AAP Toilet Training Recommendations And The Role Of Primary Care Providers**
Ellen Defenderfer, Eva Iglar, Jillian E. Austin & W. Hobart Davies
50. **The Value Of Behavioral Health Consultants Integrated In Pediatric Primary Care Settings**
Lynn Vanderwielen, John Laukkanen, Brigitte McClellan & Orlando Padilla
51. **The Impact Of Comorbid ADHD On Emotional Functioning In Children With Asthma**
Adrienne Borschuk, Stephanie Luck & Robin Everhart
52. **Improving Patient Safety And Assessing Barriers In The Home Setting For Patients With Tracheostomies Using Heated Humidification**
Antonio Igbokidi, Brandi Whitaker, Brandi Willis & Brandi N. Schellhase
53. **Developing Evidence-Informed And Clinically Accessible Preparation For Pediatric MRI: A Needs Assessment Study**
Melissa Howlett, Michelle Lehman, Lori Watanabe, Pierre Schmit & Jill Chorney
54. **Implementation Of A Digitized Medication Program Leads To More Holistic Treatment Approach For The School-Aged Transplant Patient**
Kelli N. Triplett, Sarah Sullivan, Gillian S. Mayersohn, Kenzie Thrasher & Dev Desai
55. **Do Children Receive Evidence Based Treatment?**
Melissa K. Hord, Stephen P. Whiteside, Jarrod M. Leffler & Leslie A. Sim
56. **Smokers With Children With Asthma: Parental Perceptions About Intervention Messages Focused On Reducing Child Secondhand Smoke Exposure And Tobacco Use Initiation**
Ashley H. Clawson, Elizabeth Mcquaid, Shira Dunsiger & Belinda Borrelli
57. **Comparisons Of Visual Attention And Externalizing Behavior Problems In Deaf Children With Cochlear Implants Vs. Hearing Peers**
Michael Hoffman, Alexandra Quittner, Tiddens Elena & Clarissa Schilstra
58. **Initial Feasibility And Efficacy Of A Summer Treatment Program For Preschoolers With Autism And Externalizing Behavior Problems**
Rosmary Ros, Della Gregg, Stephanie Munio, Katie Hart & Paulo Graziano
59. **Hope As A Moderator Of The Relationship Between Depression And BMI Percentile In An Adolescent Sample**
Dianna M. Boone, Zohal Heidari, Emily Christie & Jason Van Allen
60. **Profile And Trends For Pediatric Binge Eating Disorder In The Weight Management Population**
Claire Wallace, Caroline Franke, Danielle Mizell, Kate Eshleman, Naim Alkhouri & Sara Lappe
61. **Preliminary Results From A Hospital Based Weight Management Program: Fit5**
Amy Gorin & Melissa Santos
62. **The Role Of Psychosocial Factors In Musculoskeletal Pain And Functional Mobility For Adolescents With Severe Obesity At 2 Years Following Bariatric Surgery**
Kelsey Borner, Jennifer Reiter-Purtill, Sharon Bout-Tabaku, Todd Jenkins, Justin Ryder, Aaron Kelly & Meg H. Zeller
63. **The Moderating Role Of Family Functioning On The Relationship Between Parental Distress And Youth Disease-Related Quality Of Life**
Marie Chardon, Molly Basch, Sarah Stromberg & David M. Janicke
64. **Concordance In Parent-Child Dyad Psychosocial Functioning And Family Impact Of Chronic Pediatric Pain**
Lauren E. Harrison & Catherine Peterson
65. **Interactions Between Parent Distress And Child Catastrophizing In Predicting Functional Disability In Chronic Pain**
Katherine R. Inman, Patrick Weaver, Lauren E. Harrison & Catherine Peterson
66. **Using Ecological Momentary Assessments To Examine Relationships Between Pain Fear, Pain Avoidance, And Pain Intensity In Children With Functional Gastrointestinal Disorders**
Tiffany Kichline, Christopher C. Cushing, Jennifer V. Schurman, Jennifer B. Blossom & Craig A. Friesen
67. **The Role Of Parent Involvement And Youth's Perception Of Parental Responses To Postural Orthostatic Tachycardia Syndrome (POTS) Symptoms Following A 6-Week Interdisciplinary Group Intervention**
Laura Gray, Megan Connolly, Marissa A. Smith, Amy Morse, Samantha Bento & Angela Fletcher
68. **Pain Sensitivity And Emotional And Physical Functioning In Youth With Complex Regional Pain Syndrome Patients**
Tali Rasooly, Corey A. Kronman, Alyssa Lebel, Navil Sethna, Lino Becerra, David Borsook & Laura E. Simons
69. **Intensive Interdisciplinary Treatment Of Children And Adolescents With Chronic Pain: A 5-Year Follow-Up Study**
Alexandra Mills, Gerard Banez & Ethan Benore

70. **Predictors Of Disease Burden In Children With Functional Abdominal Pain**
Jacqueline Newman Warner, Anjana Jagpal, Erin Moorman, Michael Farrell & Natoshia Cunningham
71. **Assessing Treatment Response Using Daily Measures Of Physical Activity, Fear, And Avoidance In Youth With Chronic Pain**
Farah Mahmud, Corey A. Kronman, Molly Basch, Cora Mukerji, Eileen Li, Ellen Mcginnis, Justin Beebe, Christine B. Sieberg & Laura E. Simons
72. **Prescription Of Opioids To Youth In A High-Risk State From 2005-2014**
Melissa Pielech, W. Evan Rivers & Kevin E. E. Vowles
73. **Teacher Report On Cooperation In Youth With Spina Bifida: Pain As A Predictor**
Diana Ohanian, Colleen Driscoll, Autumn Crowe, Priscilla Yofon & Grayson N. Holmbeck
74. **Analysis Of Recent Trends In Psychological Interventions For Needle-Related Pain And Distress In Childhood: A Cochrane Systematic Review**
Kathryn A. Birnie, Melanie Noel, Jennifer Stinson & Christine T. Chambers
75. **Rapid Screening Of Prognostic Risk In Pediatric Headache: Application Of The Pediatric Pain Screening Tool (PPST)**
Lauren C. Heathcote, Jonathan Rabner, Alyssa Lebel & Laura E. Simons
76. **Predictors Of Treatment Adherence Among Adolescents With Chronic Pain**
Richa Aggarwal, Deborah Drabick & Katherine S. Salamon
77. **Psychosocial Predictors And Trajectories Of Chronic Postoperative Pain Following Hip Preservation Surgery**
Christine B. Sieberg, Cindy Wong, Justyna Klajn, Garrett Bowen, Laura E. Simons & Michael B. Millis
78. **The Effect Of Day-To-Day Variability In Maternal Physical Activity On Toddler Physical Activity**
Bridget Armstrong & Maureen Black
79. **Development Of Illustrated Vignettes To Examine Illness Communication And Coping Behaviors In Children And Adolescents**
Jillian H. Filliter, Kate Aubrey, Isabel M. Smith & Shannon Johnson
80. **A Case-Controlled Study Of Fatigue And Sleep Disturbances In Adolescents With Spina Bifida Vs Typically Developing Peers**
Caitlin Murray, Grayson N. Holmbeck & Tonya M. Palermo
81. **Effect Of Sleep Duration On Food-Related Executive Control In Normal And Overweight Adolescents**
Kimberly Anne. Barnett, Kaylie A. Carbine, Kara Duraccio, Kimberly Stevens, Kirandeep Kaur & Chad Jensen
82. **Sleep Hygiene In Adolescents With Asthma**
Casey Lawless, Mallory Netz, Elise Turner, Andrew Mcconville, Elizabeth Lefave, Daphne Koinis Mitchell & David A. Fedele
83. **Actigraph Technology Informs Interdisciplinary Assessment And Intervention For Sleep Disturbances In Young Children**
Cyd Eaton, Ellen Henning, Janet Lam & Valerie Paasch
84. **Family Disorganization Is Associated With Sleep Problems In School-Aged Children**
Carolyn Bates & Amy Bohnert

SATURDAY, APRIL 1—POSTER SESSION 4

11:45 a.m.–12:45 p.m.
Exhibit Hall

1. **Effects On Socioeconomic Status On Knowledge Of xDisease Management In Cystic Fibrosis**
Christina J. Nicolais, Kristin Riekert & Alexandra Quittner
2. **Barriers To Adherence, Psychosocial Functioning, And Perceived Social Support In Pediatric Patients Awaiting Transplantation**
Grace Cushman, Ana Gutierrez-Colina, Cyd Eaton, Colleen Keeler, Lindsay Rosenthal, Jennifer L. Lee, Lauren Quast, Bonney Reed-Knight, Kristin Loiselle. Rich, Laura L. Mee, Rochelle Liverman & Ronald Blount
3. **An Analysis Of Provider-Patient Communication About Medication Prescriptions Using The CAMP-AYA**
Lindsey Bugno, Jill Plevinsky, Samantha Carreon, Eva Iglar, W. Hobart Davies & Rachel Greenley
4. **Effects Of Father Support In Adolescence On Self-Rated Physical Health In Young Adulthood**
Mariam Hanna. Ibrahim, Linda Luecken & Sharlene Wolchik
5. **Electronic Cigarette Expectancies In Adolescents: Differences As A Function Of Use**
Hayley Harman, Desirée Williford, Lisa Hynes, Paul Enlow, Evan Turner, Pamela Murray, Christine Banvard & Christina L. Duncan
6. **Asthma, Depressive Symptomatology, And Smoking Behavior Among Adolescents: A Family Systems Perspective**
Jessica Pappagianopoulos & Sasha Fleary
7. **Discrepancies In Knowledge Of Clinical Trials Among Adolescents And Young Adults With A History Of Cancer And Their Caregivers: Associations With Developmental Maturity**
Alexandra Psihogios, Lisa A. Schwartz & Lamia P. Barakat
8. **Personality And Psychological Symptoms Associated With Transition Readiness In Adolescent And Young Adult Transplant Recipients**
Lauren Quast, Ana Gutiérrez-Colina, Lindsay Rosenthal, Cyd Eaton, Jennifer L. Lee, Bonney Reed-Knight, Laura L. Mee, Rene Romero & Ronald Blount
9. **Transition Planning: Examining Differences Based On Illness And Psychosocial Comorbidities**
Jeannette Iskander, Kara S. Monnin & Beth Wildman
10. **Maladaptive Coping Predicts Emotional And Social Functioning Among Adolescents With Cystic Fibrosis**
Christina D'Angelo & Sylvie Mrug

11. **Predictors Of Higher Cortisol Reactivity In Adolescents: Perceived Stress And Trait Anger**
Jessica K. Pogue, Maren Hankey, Taylor C. Roth, Jennifer Mize Nelson, Kimberly Andrews Espy & Timothy D. Nelson
12. **Communication About Sexual Behavior In Mothers Of Adolescents With Chronic Illnesses: The Role Of Positive Outcome Expectancy**
Jessica Naftaly & Rachel Greenley
13. **The Role Of Stigma In The Relationship Between Illness Intrusiveness And Depression/Anxiety: A Path Model**
Dana M. Bakula, Christina M. Sharkey, Megan N. Perez, Kaitlyn L. Gamwell, Alexandria J. Mullins, John M. Chaney & Larry L. Mullins
14. **The Social-Emotional Profile Of Girls And Women With Turner Syndrome Across The Lifespan**
Molly Colvin, Lea Travers, Angela Lin, Erin Mcnamara & Amy Morgan
15. **Parenting Stress, Mindfulness, And Adjustment In Parents Of Young Children Diagnosed With Congenital Heart Disease**
Meredith Bishop, Nikita Rodrigues, Sharon Shih, Matthew Donati, Anna E. Evans, Sarah O. Morris & Lindsey L. Cohen
16. **Communication And Perceived Health Competence In Adolescents And Young Adults With Congenital Heart Disease**
Emeric Quade, Kyle Schofield, Jamie Jackson & Kathryn Vannatta
17. **Integrated Team Approach To Adolescents Treated With Hip Preservation Surgery**
Heather M. Richard, Shelby L. Parker, Adriana De La Rocha & David A. Podeszwa
18. **Investigation Of Pediatric Psychology: The Utilization And Collaboration With Consult-Liaison Services At UM/Jackson Memorial Hospital**
Priyanka Doshi & Melisa Oliva
19. **Integrating Psychology Into A Newly Formed Multidisciplinary Center: Assessing The Psychological Needs Of Patients With Vascular Anomalies**
Dara M. Steinberg, Ionela Iacobas, Judith Margolin & Virginia Depp Cline
20. **Patterns Of Socio-Economic Status Factors Within A Primarily Low-Income Sample Of Adolescents With Type 1 Diabetes**
Gabrielle Banks, Kristoffer Berlin, Kimberly Klages, Tiffany Rybak, Jeanelle Ali, Katherine Semenkovich, Rachel Ankney, Riply Wood, Tawana Smith, Ramin Alemzadah, Alicia Diaz-Thomas & Angelica Eddington
21. **Implementation Of Psychological Screening In A Speciality Care Clinic**
Harpreet Nagra, Torianne Ipema, Laine Atcheson, Hawer Kadir & Danny Duke
22. **Hypoglycemia Fear And Limited Use Of Diabetes Technologies Relate To Increased Sedentary Behavior In Young Children**
Amy E. Noser, Ali Calkins, Mark A. Clements, Genevieve Maliszewski & Susana R. Patton
23. **Diabetes Disclosure And Support-Seeking Styles In Adolescents And Young Adults (Ayas) With Type 1 Diabetes (T1D).**
Andrea Pihlaskari, Barbara J. Anderson, Sahar S. Eshtehardi, Brett M. Mckinney, David G. Marrero & Marisa E. Hilliard
24. **Pathways To Disordered Eating Among Adolescents And Young Adults With Type 1 Diabetes In The T1D Exchange Clinic Registry**
Laura B. Smith, Diana Rancourt, Nicole Foster, Sureka Bollepalli, Margaret Powers & Mark A. Clements
25. **Shared Responsibility For Diabetes Care Reduces Risk Of Glycemic Excursions In Youth**
Arwen M. Marker, Amy E. Noser, Mark A. Clements & Susana R. Patton
26. **Ideal Weight: A Possible Indicator Of Eating Disordered Attitudes And Behaviors In Pediatric Patients With Type I Diabetes**
Colleen Stiles-Shields & Tina Drossos
27. **Multidisciplinary Collaboration And Training On A Diabetes Team With Psychology Graduate Students**
Kelsy Newton, Tara Sharifan, Sara Fligelman, Kate Raineri, Sevket Yigit & Laura Edwards-Leeper
28. **The Impact Of Family Conflict On Glycemic Control In Adolescents With Type 1 Diabetes**
Amanda Warning, Jennifer Rohan, Jennifer Shroff Pendley, Alan Delamater & Dennis Drotar
29. **The Impact Of Sociodemographic Factors And Cumulative Risk On Health-Related, Neuropsychological, And Psychosocial Functioning Among Youth With Spina Bifida: Age And Gender As Moderators**
Jaclyn L. Papadakis, Nerissa Fernandes, Elzbieta Kalata & Grayson N. Holmbeck
30. **Parent-Reported Patterns Of Sibling Supervision In Rural Uganda**
Marissa Swanson & David Schwebel
31. **Recommendations For Children With Failure To Thrive: A Taxonomy From An Interdisciplinary Clinic**
Jennie G. David, Karen E. Wolff, Brittanie L. Blanchard, Adina R. Freedman, Angel J. Smith, Melissa Melendez, Hans B. Kersten & David S. Bennett
32. **Treatment Of Severe Food Selectivity In School-Age Children Using Graded Exposure**
Natalie Morris, Kathryn Stubbs, Kristen Criado, Rashelle Berry, Barbara Mcelhanon, Aleksandra Krupina & William Sharp
33. **Risk-Taking, Adherence, And Health Outcomes In Adolescents With Epilepsy**
Aimee Smith, Shannon Ollier, Angela Combs, Krista Mann & Avani Modi
34. **Parent-Child Relationship Factors And Pain Coping In Pediatric Inflammatory Bowel Disease**
Ellen Manegold, Evan Turner, Margo M. Szabo, Laila Sakkal, Brian Riedel, Jonathan Moses, Audra Rouster & Christina L. Duncan
35. **Psychological Profiles Among Adolescents Treated In An Inpatient Rumination Syndrome Program**
Sarah Mayer-Brown, Parker Huston & Anthony Alioto

36. **Psychosocial Functioning As A Predictor Of Family Conflict Among Families Of Adolescents With Inflammatory Bowel Diseases**
Natasha Pouloupoulos & Rachel Greenley
37. **Associations Among Stress, Threat Appraisals, And Emotional Problems In Children With Pediatric Cancer**
Katlyn Garr, Jessica Greenlee, Marcia Winter & Nour Al Ghriwati
38. **Identifying Risk Factors For Emotional And Behavioral Difficulties In Youth Prior To Bone Marrow Transplant.**
Kaushalendra Amatya, Margo M. Szabo And Anna George
39. **Pica In Pediatric Sickle Cell Disease: The Development Of A Treatment Program**
Sharon Shih, Lindsey L. Cohen, Nikita Rodrigues, Soumitri Sil, Beth Thompson & Alcuin Johnson
40. **Grief And Growth Following A Sibling's Death From Cancer: Interactions Between Different Sources Of Social Support**
Katieanne M. Howard Sharp, Amanda C. Ferrante, Queen-Erin Watson, Adrien Winning, Claire Russell, Maru Barrerra, Bruce Compas, Diane Fairclough, Terrah Foster Akard, Mary Jo Gilmer, Tammi Young-Saleme, Kathryn Vannatta & Cynthia Gerhardt
41. **The Impact Of Coping On The Adjustment Of Bereaved Siblings After A Child's Death From Cancer**
Queen-Erin Watson, Adrien Winning, Amanda C. Ferrante, Katieanne M. Howard Sharp, Maru Barrerra, Bruce Compas, Diane Fairclough, Terrah Foster Akard, Mary Jo Gilmer, Tammi Young-Saleme, Kathryn Vannatta & Cynthia Gerhardt
42. **The Moderating Role Of The Parental Relationship On The Expression Of Depression And Anxiety In Adolescents And Young Adult Oncology Survivors**
Sara E. Harris, Arie Zakaryan, Nadia Torres-Eaton, Alicia Wuth & Lillibeth Torno
43. **Emotional Adjustment In Pediatric Brain Tumor Survivors: The Role Of Medical Late Effects And Family Environment**
Kathryn Balistreri, Jennifer Monti, Mary Hagan, Cynthia Gerhardt, Andrea Patenaude, Maru Barrerra & Kathryn Vannatta
44. **Development Of Web-Based Decision Support Tool: DECIDES**
Elizabeth S. Ver Hoeve, Lisa A. Schwartz, Marilyn M. Schapira, Janet A. Deatrick, Evelyn Stevens, Alexandra Psihogios, Anne Reilly & Lamia P. Barakat
45. **The Relationship Of Illness Uncertainty And Rumination To Posttraumatic Stress Symptoms In Parents Of Children Newly Diagnosed With Cancer: A Mediation Model**
Megan N. Perez, Alayna P. Tackett, Christina M. Sharkey, Alexandria J. Mullins, Marissa Baudino, Sunnye Mayes, Rene Mcnall-Knapp & Larry L. Mullins
46. **Measuring Emotion Socialization In Families Affected By Pediatric Cancer**
Ana F. El-Behadli, Danette Beitra & Melissa A. Faith
47. **Behavioral Health Consultation For Premature Infants And Their Families In Primary Care**
Verenea Serrano & Ayelet Talmi
48. **Description Of Interprofessional Education Initiatives: Psychology And Pediatrics**
Britt Nielsen
49. **Integrated Behavioral Healthcare: Changing Practices Following Six Years Of Implementation**
Caitlin Rasplia, Andrew R. Riley, Lauren M. Fussner, Jenna Paternostro, Kim Reynolds & Kurt A. Freeman
50. **Communication And Collaboration Between Pediatric School Psychologists And School Nurses To Promote Integrated Health Care**
Kayla Larosa, Courtney Lynn, Katherine Wesley & Kathy Bradley-Klug
51. **Parents' Sources Of Time-Out Information In Pediatric Primary Care**
Jennifer Paternostro, Andrew R. Riley, David V. Wagner, Kurt A. Freeman, Megan Tudor & Katharine Zuckerman
52. **The Role Of Ethnicity And Language In Children's Preoperative Anxiety**
Kim Har, Pragati Mamtora, Zeev Kain & Michelle A. Fortier
53. **Examination Of Posttraumatic Stress Symptoms In Parents Of Children With A DSD**
Alexandria J. Mullins, Kristina Suorsa, Dana M. Bakula, Christina M. Sharkey, Kaitlyn Gamwell, Megan N. Perez, Kristy Reyes, Amy Wisniewski & Larry L. Mullins
54. **An Evaluation Of The Society Of Pediatric Psychology Mentoring Project**
Christina M. Amaro, Amy E. Noser, Emma E. Rogers, Michael C. Roberts, Sharon Berry & Joanna Thome Patten
55. **Objective Treatment Burden As A Predictor Of Health Related Quality Of Life In Pediatric Cystic Fibrosis**
Ashley Ramos, Gillian S. Mayersohn, Roy Kim & Jamie Becker
56. **Quality Of Life In Pediatric End-Stage Renal Disease Dialysis Patients: Respondent Discrepancy And The Role Of Treatment Modality**
Cortney Taylor
57. **Development And Application Of The Youth Health Resiliency Scale- Youth Version: A Tool To Bridge The Gap Between Pediatric Psychologists And Medical Providers**
Courtney Lynn, Kathy Bradley-Klug, Emily Shaffer-Hudkins & Jessica N. Montgomery
58. **End Of Life Care In The NICU From The Perspective Of Bereaved Parents**
Christine A. Fortney, Amy Baughcum, Cynthia Gerhardt, Adrien Winning, Queen-Erin Watson, Emily Shultz & Madelaine Keim
59. **Parental Experiential Avoidance Mediates The Association Between Parent Psychopathology And Controlling Child Feeding Practices**
Amy Fahrenkamp, Katherine Darling, Elizabeth Ruzicka & Amy Sato

60. **Predictors Of Attrition In A Pediatric Weight Management Program**
Nicole Andorko, Elizabeth Getzoff Testa & David Clinton
61. **The Influence Of Sleep Duration On Hedonic Reward Of Food In Normal Weight And Overweight Adolescents**
Kara Duraccio, Michaela Billat, Kimberly Anne. Barnett & Chad Jensen
62. **Body Dissatisfaction In A Sample Of Children With IDD And Obesity/Overweight**
Catherine Sanner, Sylvia Herbozo, Lilit Hovsepyan, Cameron Neece, & Allyson L. Davis
63. **Family Mealtime Functioning Moderates The Relationship Between Youth Body Dissatisfaction And Weight Control Behavior Use**
Sarah Stromberg, Marie Chardon & David M. Janicke
64. **Effects Of Acculturation Risk Factors And Parental Psychopathology On Latino Adolescent Somatic Complaints**
Theresa Kapke, Kim Anderson Khan, Chasity Brimeyer, Kathryn Lawton & Alyson Gerdes
65. **Medicalization And Parental Protective Behaviors In Pediatric Chronic Pain**
Bernadette Lewcun, Traci M. Kennedy, Aimee K. Hildenbrand, Kimberly Miller, Danielle Weiss, Jennifer Sherker & David D. Sherry
66. **Child Somatization Inventory (CSI-24): Examining Clinical Reference Points In Relation To Pain Diagnosis And Healthcare Use.**
Jessica Maya Hernandez, Molly C. Basch, Lauren C. Heathcote, Sarah Perlo, Lynn S. Walker & Laura E. Simons
67. **Coping And Health-Related Quality Of Life Within A Multidisciplinary Approach To Pediatric Pain**
Jessica Hoehn, Amy Hahn, Jenny Evans & Kathy L. Lemanek
68. **Sharing Of Child Health Information Over Social Media: An Evaluation Of Posts Shared Over Social Media About Pediatric Pain And Pediatric Sleep**
Michelle Tougas, Christine T. Chambers, Penny Corkum, Julie Robillard, Anatoliy Gruzd, Vivian Howard, Andrea Kampen & Katelynn E. Boerner
69. **Peer Functioning In Pediatric Chronic Pain: Relationships Among Risk Factors And Functional Outcomes In A Referred Sample**
Hannah Mckillop, Gerard Banez & Ethan Benore
70. **Isometric Exercise Increases Immediate Pain Tolerance In Young Adults: Future Possibilities For Pediatric Acute Pain Management**
Emily Foxen-Craft & Lynnda Dahlquist
71. **Chronic Pain, Anxiety And Functional Disability: Weight Concerns Further Complicate The Puzzle**
Monica L. Gremillion, Keri Hainsworth, Kim Anderson Khan, Renee Ludwig, Chasity Brimeyer, Heather Wolf & Steven J. Weisman
72. **Adolescent Patients With Functional Abdominal Pain Can Be Classified Into Three Subgroups With Different Pain Profiles**
Sarena Martinez, Amanda L. Stone, Amy R. Boegel, Craig A. Smith & Lynn S. Walker
73. **Can Brief Programs Impact Chronic Pediatric Pain? Results From A Preliminary Study**
Kendra Homan, Cynthia Harbeck-Weber, Shelley Ahrens & Margo Scott
74. **Preliminary Examination Of Three Month Follow-Up Data For Youth Treated In Multidisciplinary Pediatric Pain Management Program**
Dara Devinney & Katherine S. Salamon
75. **"Parents As Coping Coaches": Preliminary Findings For A Group Intervention For Parents Of Adolescents With Chronic Pain**
Jessica W. Guite, Beth Russell, Ashley Pantaleao, Anne Thompson Heller, Erin Donohue, Victoria Galica, William Zempsky & Christine Ohannessian
76. **Setting Goals For Psychological Treatment For Chronic Pain: Does Agreement Between Adolescents And Their Parents Matter?**
Emma Fisher, Jake Bromberg, Gabrielle Tai & Tonya M. Palermo
77. **Caregivers' Perceptions Of Asthma, Fear Of Asthma, And Exercise As A Trigger For Asthma: Correspondence With Objective Assessments Of Lung Function And Exercise Challenge Tests In Urban Children**
Daphne Koinis Mitchell, Sheryl Kopel, Elizabeth Mcquaid, Cynitha Esteban, Ronald Seifer, Patricia Mitchell, Nico Vehse, Robert Klein & Elissa Jelalian
78. **Differences In And Correlates Of Home, School, And Non-School Sedentary Time**
Andrea Garcia, Jordan Carlson, Brian Saelens, Jacqueline Kerr, Terry Conway, Lawrence Frank, Kelli Cain & James Sallis
79. **Results From A Longitudinal Study To Predict Posttraumatic Stress In Children After Injury**
Meghan L. Marsac, Nancy Kassam-Adams, Douglass Delahanty, Jeffrey Cielsa, Danielle Weiss, Keith Widaman & Lamia P. Barakat
80. **The Relationships Among Parenting Style, Child Sleep, And Child Daytime Behavior**
Danielle Chambers, Karla K. Fehr & Jennifer Ramasami
81. **Behavioral And Cognitive-Behavioral Intervention For Treating Dysautonomia-Related Sleep Disturbance In A Youth With Ehlers Danlos Syndrome**
R. Elyse Heidelberg & Keith Slifer
82. **Psychiatric Functioning Predicts Worse Insomnia And Poorer Treatment Response In Youth Clinically Referred For Insomnia Treatment**
Tori R. Van Dyk & Kelly C. Byars
83. **Development And Validation Of The Adolescent Insomnia Questionnaire**
Jake & Bromberg, Megan Lounds & Tonya M. Palermo
84. **Predictors Of Compliance With And Reactions To The American Academy Of Pediatrics' Safe Sleep Guidelines**
Jillian E. Austin, Lizbeth Lopz & W. Hobart Davies

CONGRATULATIONS TO THE 2017 SPP AWARD WINNERS

SOCIETY OF PEDIATRIC PSYCHOLOGY AWARDS

Carolyn S. Schroeder Award for Outstanding Clinical Practice:

Anthony Alioto, PhD

Dennis Drotar Distinguished Research Award:

David Schwebel, PhD

Donald K. Routh Early Career Award:

Christopher Cushing, PhD & David Fedele, PhD

SPP Award for Outstanding Mentorship:

Elizabeth McQuaid, PhD, ABPP

Wright Ross Salk Award for Distinguished Service:

Kathy Lemanek, PhD

SPP Award for Distinguished Contributions to Diversity:

John Chaney, PhD

C. EUGENE WALKER EDUCATION AWARD IN PEDIATRIC PSYCHOLOGY WINNER

Bridget Armstrong, PhD – University of Maryland School of Medicine

Mentors: Dr. Lori Stark and Dr. David Janicke

STUDENT TRAVEL AWARD WINNERS

Nour Al Ghriwati – A Cross-Lagged Model of Bio-behavioral and Family Processes in Pediatric Asthma

Lindsay Anderson – A Pilot Mobile Health Intervention Aimed to Increase Adherence and Quality of Life in Pediatric Sickle Cell Disease

Carolina Bejarano – An EMA study of sleep, affect, and palatable food consumption in adolescents

Natalie Benjamin – Take your best guess: Using error grid analysis to measure blood glucose estimation accuracy in adolescents with type 1 diabetes

Ruth Bernstein – Effects of socioeconomic status on knowledge of disease management in cystic fibrosis

Laura Caccavale – Exploring the role of motivational interviewing in adolescent patient-provider communication about type 1 diabetes

Marie Chardon – The Moderating Role of Family Functioning on the Relationship between Parental Distress and Youth Disease-Related Quality of Life

Laura Cousins – Exploring the Mediating Role of Adolescent Pain Acceptance on Caregiver Psychological Flexibility and Perceived Adolescent Sickle Cell Disease Burden

Cyd Eaton – Actigraph Technology Informs Interdisciplinary Assessment and Intervention for Sleep Disturbances in Young Children

Kaitlyn Gamwell – Perceived Stigma, Social Isolation, and Depressive Symptoms in Youth with Inflammatory Bowel Disease (IBD)

Ana Gutierrez-Colina – Sleep and Psychosocial Adjustment in Pediatric Patients Awaiting Transplantation

Rebecca Kamody – Culturally Responsive Assessments and Interventions to Address Pediatric Obesity: A Collaborative Symposium of the Diversity and Obesity SIG

Caitlin Murray – A Case-Controlled Study of Fatigue and Sleep Disturbances in Adolescents with Spina Bifida vs Typically Developing Peers

Megan Perez – The Relationship of Illness Uncertainty and Rumination to Posttraumatic Stress Symptoms in Parents of Children Newly Diagnosed with Cancer: A Mediation Model

Jessie Pogue – Predictors of Higher Cortisol Reactivity in Adolescents: Perceived Stress and Trait Anger

Lauren Quast – Personality and Psychological Symptoms Associated with Transition Readiness in Adolescent and Young Adult Transplant Recipients

Alexa Stern – Influence of IQ on academic achievement in youth with Spina Bifida: Examining self-advocacy skills as potential mediators

Sarah Stromberg – Family Mealtime Functioning Moderates the Relationship between Youth Body Dissatisfaction and Weight Control Behavior Use

Rachel Sweeney – Sleep Disturbance, Quality of Life, and Asthma Status in Youth

Carolyn Turek – Age at Diagnosis of Type 1 Diabetes, Social Support, and Glycemic Control in Children and Adolescents

PORTLAND MARRIOTT DOWNTOWN WATERFRONT MEETING ROOMS

MAIN LOBBY



LOWER LEVEL 1

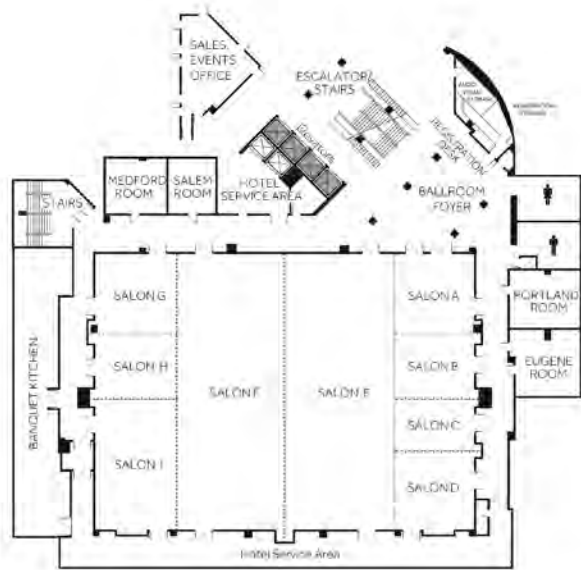

2ND FLOOR



3RD FLOOR

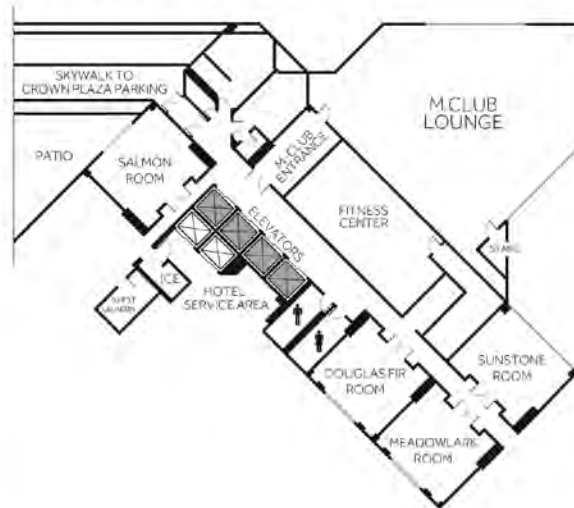

EXHIBIT LEVEL

